



Raeburn Avenue, KT5

£1,050,000

Dexters



Raeburn Avenue, KT5

This spacious semi-detached family home has four reception rooms, five bedrooms, two bathrooms, downstairs w/c, a large garden and off-street parking for several cars. There is also potential to extend (STPP), an outbuilding and no onward chain.

On the ground floor, there is a welcoming entrance hallway with a guest w/c, a bay-fronted reception room, a double reception/dining room with bi-folding doors, modern kitchen and a fourth reception room/sixth bedroom with en suite shower room.

On the first floor, there are five bedrooms and a family bathroom. There is also a large loft for storage and the potential to extend into (STPP).

Outside, there is a large private rear garden with an outhouse. To the front, there is a carriage driveway with off-street parking for several cars. To book in a viewing, please do call us on 020 8390 3939.

Raeburn Avenue is in the family-friendly area of Berrylands, approximately a mile away from four mainline train stations and in great catchment area for excellent local schools.

Features

- Semi-Detached
- Four Reception Rooms
- Five Bedrooms
- Two Bathrooms
- Off-Street Parking
- No Onward Chain







Raeburn Avenue, Surbiton, KT5

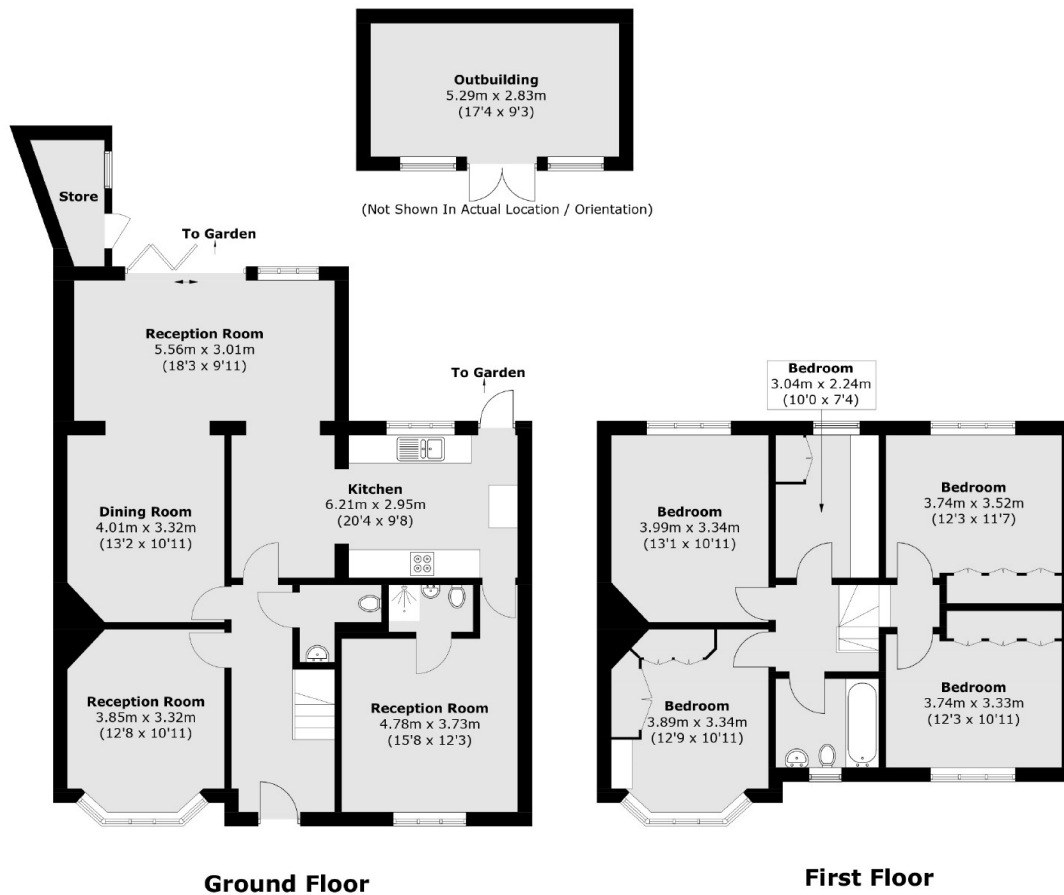

Total area (approx.): 166.1 sq. m (1,787.9 sq. ft)
Outbuilding / Store area (approx.): 18.4 sq. m (198.0 sq. ft)