



St. Mark's Hill, KT6

£479,950

A beautifully presented, large top floor, two double bedroom apartment set within an attractive mansion block. This property is ideally located in central Surbiton, it has a separate kitchen and living areas and two generous bedrooms.

St Marks Hill is nestled in the heart of Surbiton with everything you need on the doorstep, including the mainline train station and a variety of shops, bars and restaurants.

Features

- Top Floor
- Two Double Bedrooms
- Central Location
- Efficient Transport Links
- Communal Balcony
- Immaculately Presented

St. Mark's Hill, Surbiton, KT6

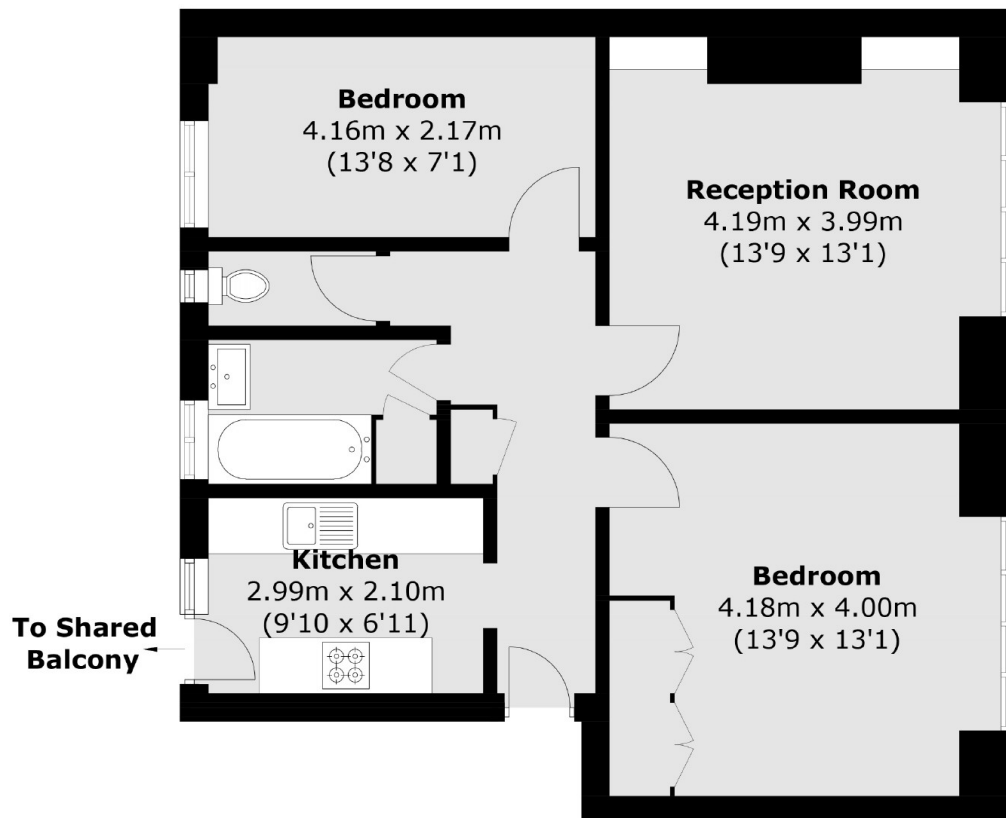

Total area (approx.): 63.2 sq. m (680.3 sq. ft)