



Hook Road, KT6

£409,950

This spacious two bedroom apartment is set back from the road in a prestigious art deco block. The property is over 800 sq ft and has a stylish kitchen, double reception room, modern bathroom, two double bedrooms and allocated parking.

The Shrubbery has easy access to the A3 and offers regular bus routes in to Surbiton and Kingston town centres. The nearest train station is Surbiton, which is 0.8 miles away and offers quick links to London.

Features

- Two Double Bedrooms
- Allocated Parking
- Over 800 sq ft
- Double Reception room
- Share Of Freehold
- Communal Gardens

Hook Road, Surbiton, KT6

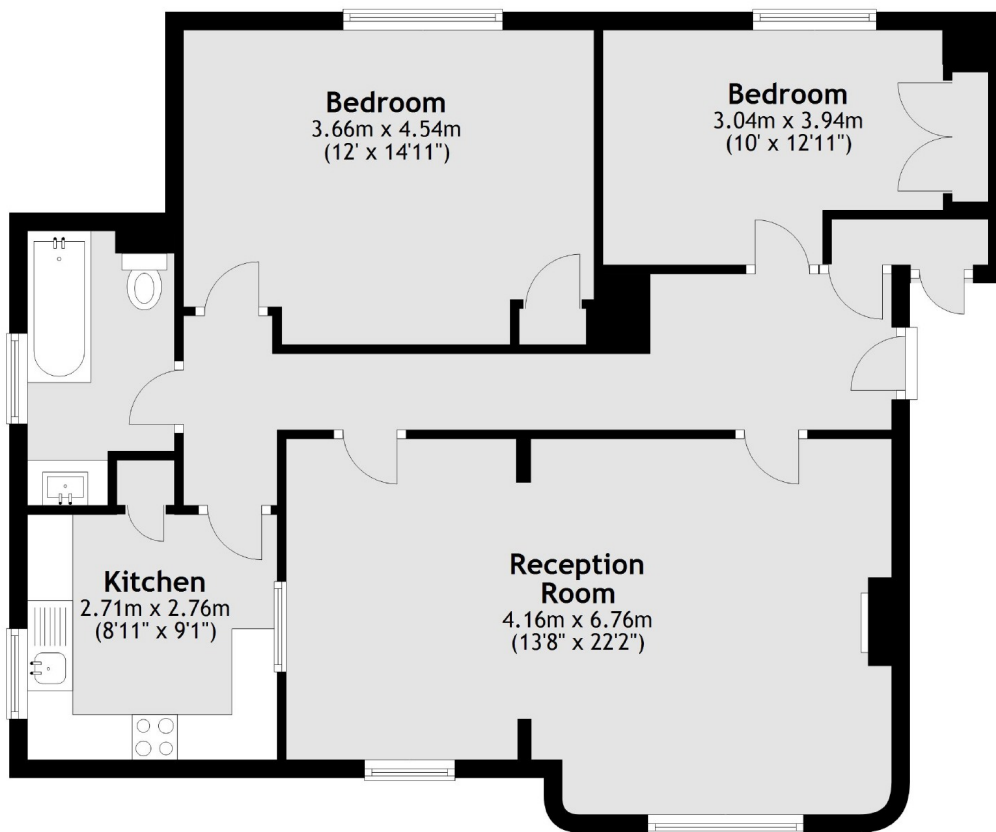

Total area: approx. 78.6 sq. metres (845.9 sq. feet)