



Broomfield Road, KT5

£489,950

This ground floor maisonette makes a great home with a reception room with doors on to the garden, a spacious kitchen/diner, two good sized double bedrooms, a private south-facing garden, off-street parking and a garage.

Broomfield Road is a peaceful and desirable residential road by Alexandra Park, and approximately a mile away from both Surbiton and Tolworth train stations, with their quick links to London Waterloo.

Features

- Ground Floor
- Two Double Bedrooms
- South-Facing Garden
- Off-Street Parking
- Garage
- Great Location

Broomfield Road, Surbiton, KT5

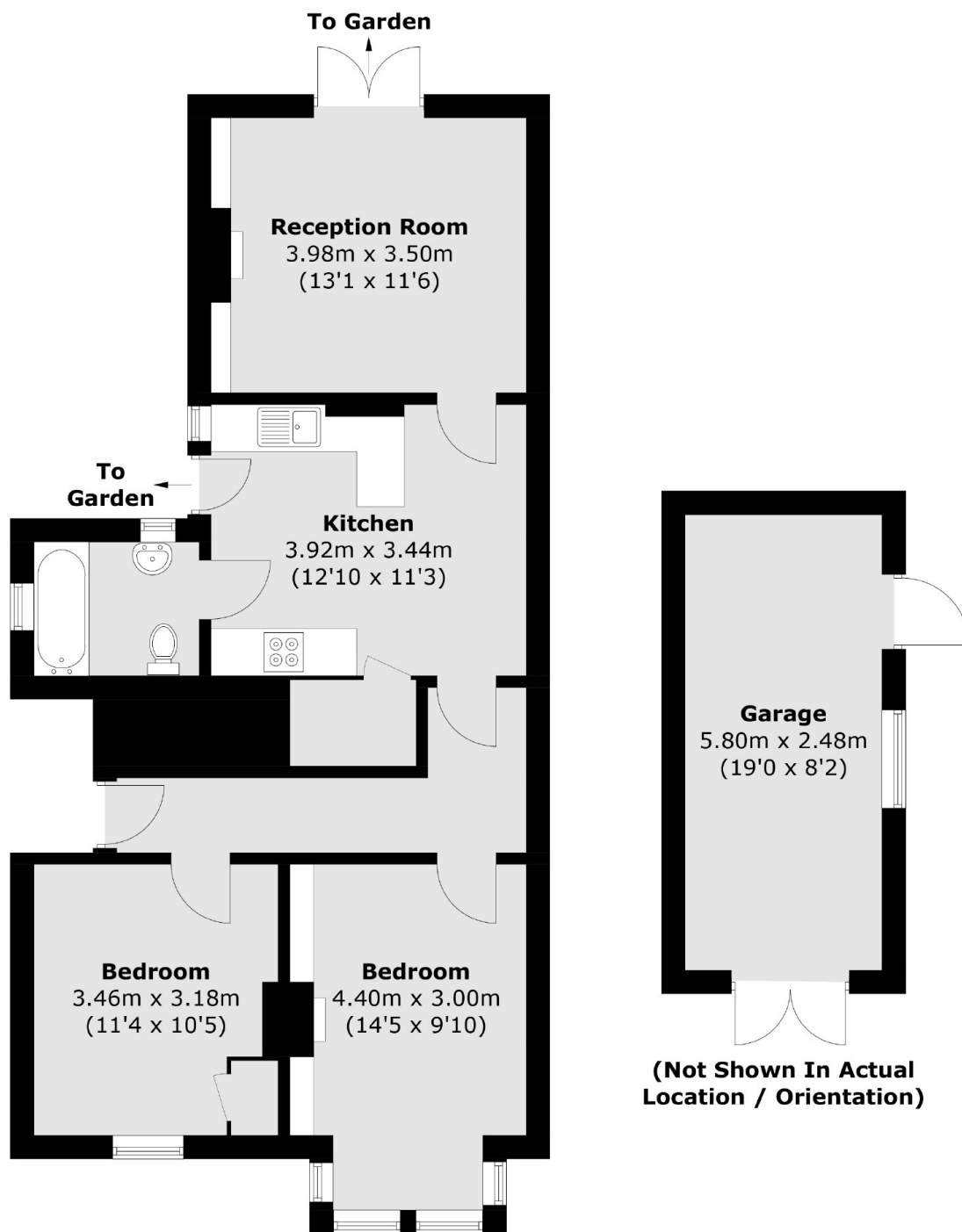

Total area (approx.): 65.7 sq. m (707.1 sq. ft)
Garage area (approx.): 14.8 sq. m (159.3 sq. ft)