



## Harlow Gardens, KT1

£350,000

A brand new development in a fantastic location. This apartment has an open plan kitchen/reception room with bi-folding doors on to a private patio, one double bedroom, an immaculate bathroom and off-street parking.

With Kingston's buzzing town centre, Surbiton high street, and both Berrylands and Surbiton mainline train stations all within one mile away, Harlow Gardens is the perfect location to live.

### Features

- New Build
- Open Plan Living
- One Double Bedroom
- Private Patio
- Off-Street Parking
- Great Location

# Harlow Gardens, Kingston Upon Thames, KT1

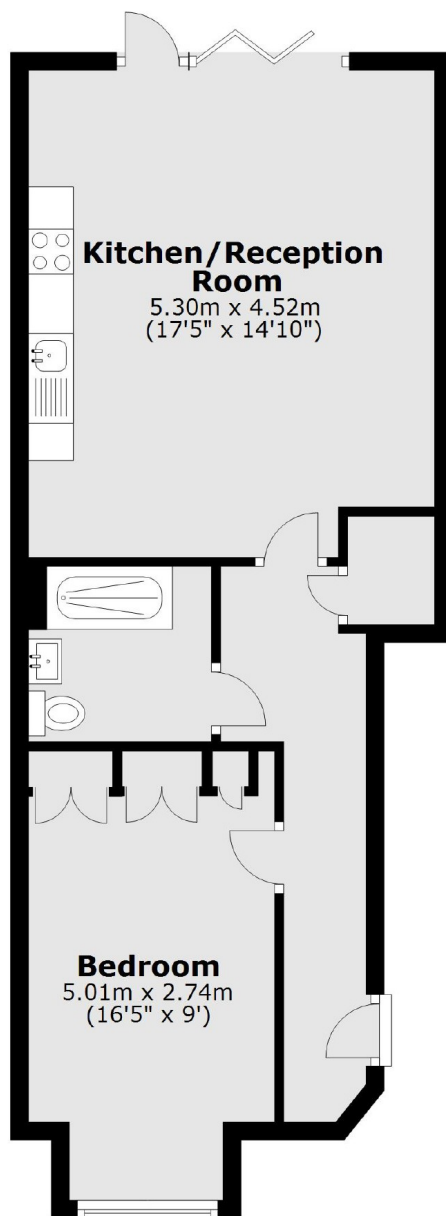

Total area: approx. 50.0 sq. metres (538.7 sq. feet)