



Tolworth Road, KT6

£599,950

This three bedroom semi-detached home offers the perfect amount of space for a family, including a large beautiful landscaped rear garden with decking, a lawn and a separate hot tub area.

Tolworth Road has easy access to the A3, is close to great local schools and is just over a mile away from both Surbiton and Tolworth town centres, with their high streets and train stations that have quick links to London.

Features

- Semi-Detached
- Three Bedrooms
- Private Garden
- Off-Street Parking
- Garage
- Great Location

Tolworth Road, Surbiton, KT6

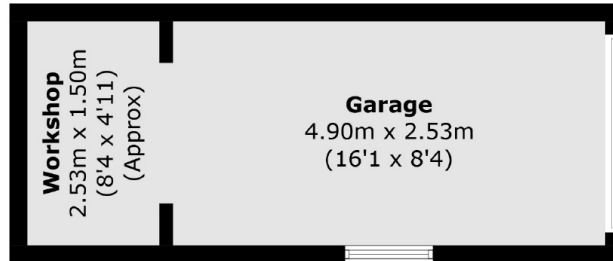

(Not Shown In Actual Location / Orientation)

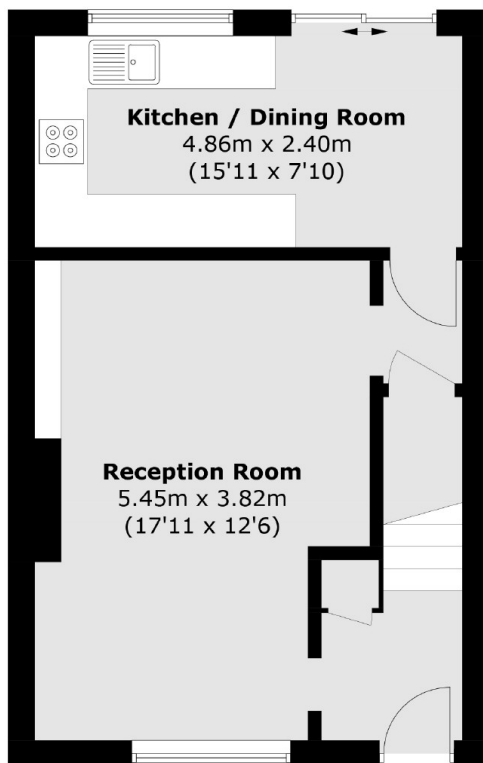

Ground Floor

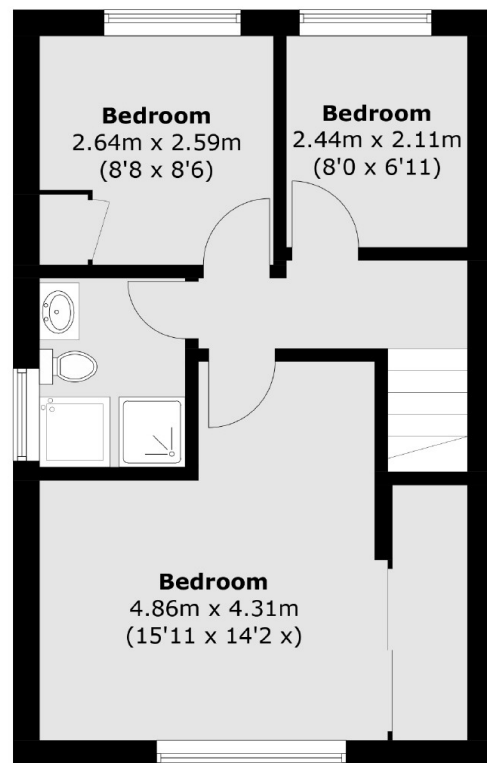

First Floor

Total area (approx.): 78.0 sq. m (839.5 sq. ft)
Garage / Workshop (approx.): 16.7 sq. m (179.7 sq. ft)