



Lower Square, TW7

£2,495 Per calendar month

A truly exceptional Georgian apartment set within a prestigious riverside development in Old Isleworth, offering generous living space and a highly desirable waterside location. The property comprises two well-proportioned double bedrooms and two bathrooms, with bright, comfortable accommodation well suited to modern living. Further benefits include an allocated parking space within a secure gated communal area and direct access to the river and towpath.

Lower Square is perfectly positioned near the riverside pubs and restaurants of Old Isleworth, moments from the Thames towpath leading into Richmond town centre, with Syon Park just a short walk away.

Features

- Georgian Apartment
- Riverside Setting
- Two Double Bedrooms
- Two Bathrooms
- Secure Parking
- Direct River Access

Lower Square, Old Isleworth, TW7

First Floor

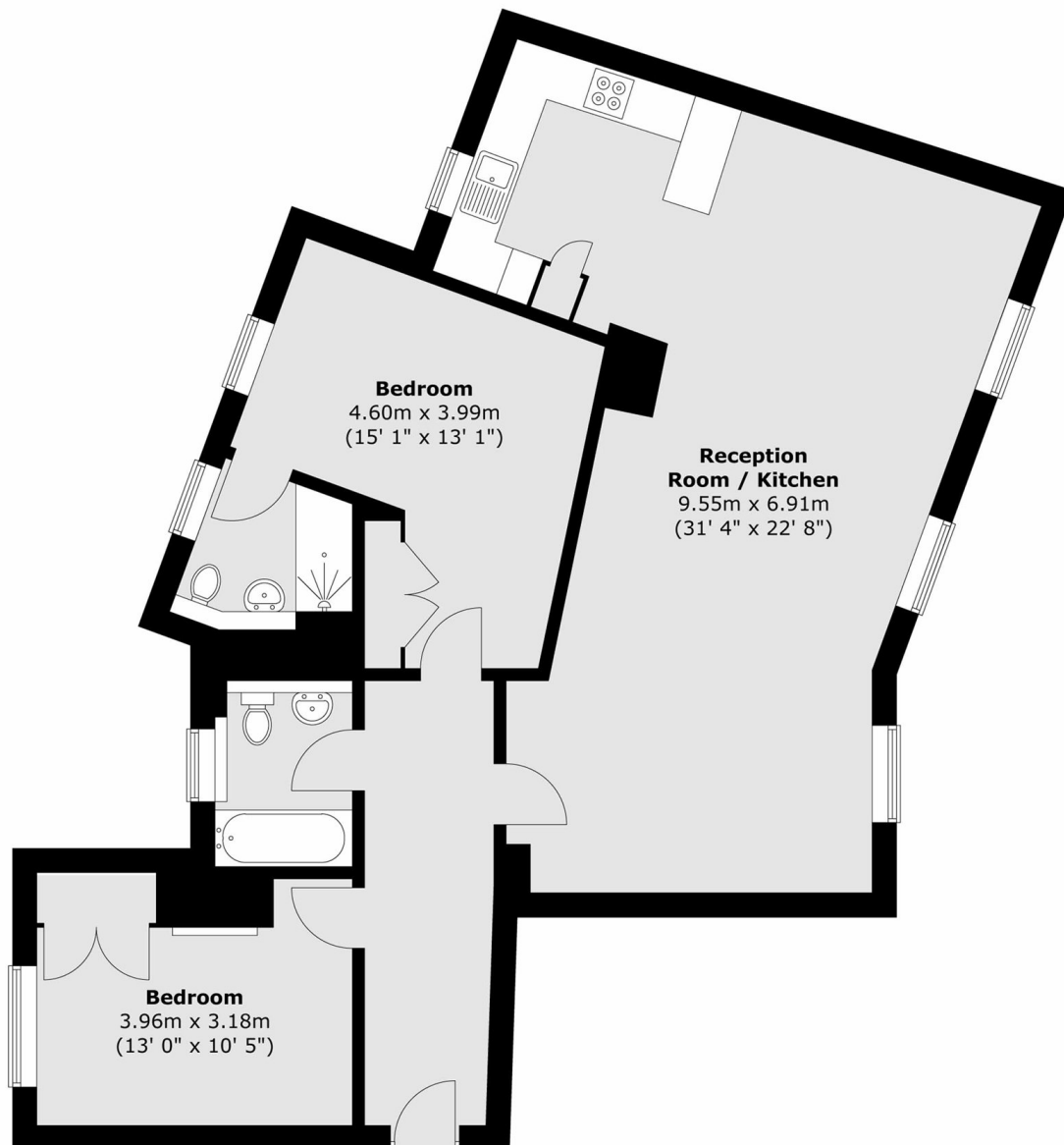

Total area (approx.) : 99.5 sq. m (1071 sq. ft)