



Chertsey Road, TW1

£1,550 Per calendar month

A beautifully presented first-floor one bedroom apartment set within a striking Art-Deco former printing press. Finished to an exceptional standard throughout, the property benefits from lift access, air conditioning, an allocated off-street parking space and a private, secure storage unit. A rare opportunity to rent a stylish home in an iconic building.

Ideally located 0.1 mile from St Margarets high street which has a good selection of boutique shops, cafes and restaurants. The mainline train station in St Margarets has links into London Waterloo. Moor Mead Park, Old Deer Park and Marble Hill Park are close by.

Features

- One Bedroom Apartment
- High Specification
- Lift Access
- Air Conditioning
- Allocated Parking
- Central Location

Chertsey Road,
St Margarets, TW1

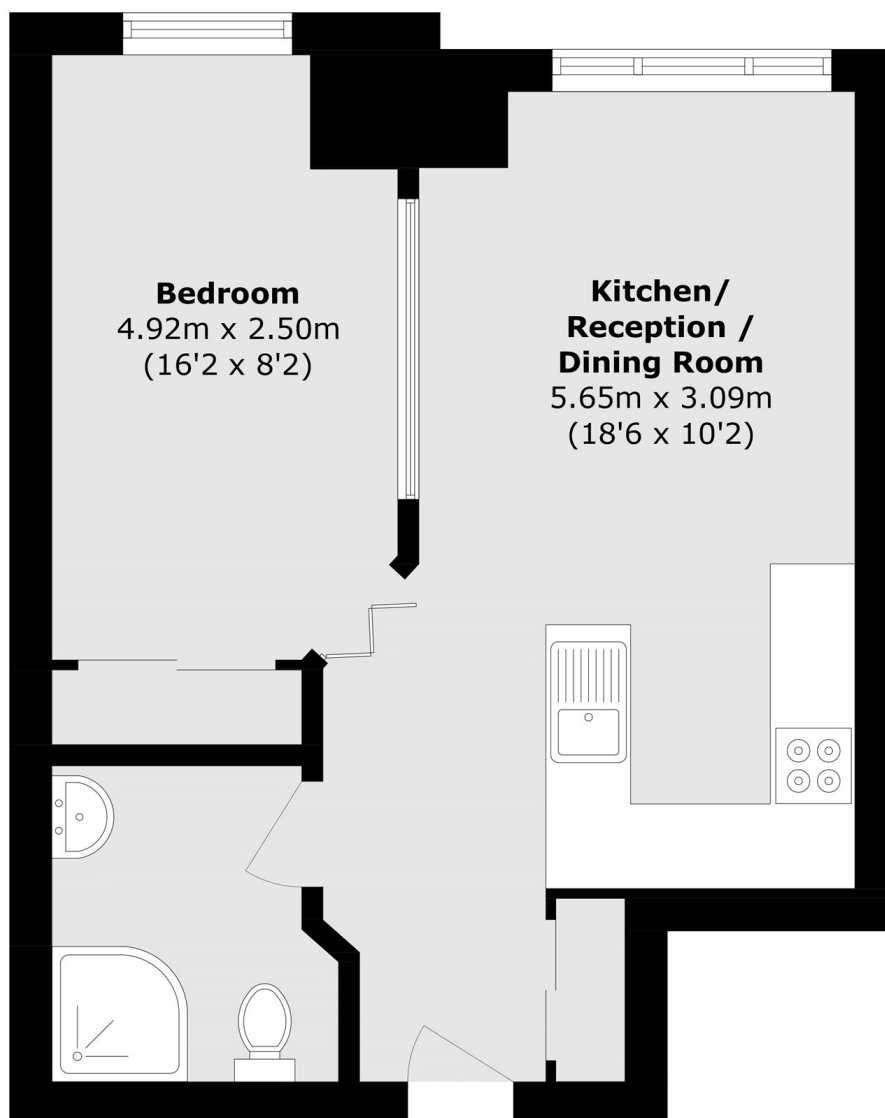

Total area (approx.): 38.3 sq. m (412.2 sq. ft)

Dexters

St Margarets
1 Chertsey Road
St Margarets
TW1 1LR
Lettings
020 8744 9700

Energy Rating: C. We aim to make our particulars both accurate and reliable. However they are not guaranteed; nor do they form part of an offer or contract. If you require clarification on any points then please contact us, especially if you're traveling some distance to view. Please note that appliances and heating systems have not been tested and therefore no warranties can be given as to their good working order.

 **RICS** | Regulated
Estate Agent
and Letting Agent

[dexters.co.uk](https://www.dexters.co.uk)