



## Ailsa Avenue, TW1

### £859,950

Situated in a popular residential location, this two/three bedroom Victorian terraced home offers a fantastic opportunity to add value and create a space tailored to your needs. The ground floor includes two reception rooms, one currently used as a bedroom, a rear kitchen and a bathroom. While upstairs offers two bedrooms and an additional bathroom. Full of original character and offered with no onward chain, the house is in need of modernisation throughout but provides plenty of scope to extend into the loft and to the rear, subject to the usual planning consents.

Ailsa Avenue is a firm favourite for our local families looking for easy access to the village, train station, the River Thames, a choice of schools, Marble Hill Park, local cafés and restaurants.

### Features

- Victorian Property
- Two/Three Bedrooms
- Two Bathrooms
- Potential To Extend STPP
- In Need Of Modernisation
- No Onward Chain

# Ailsa Avenue, St Margarets, TW1

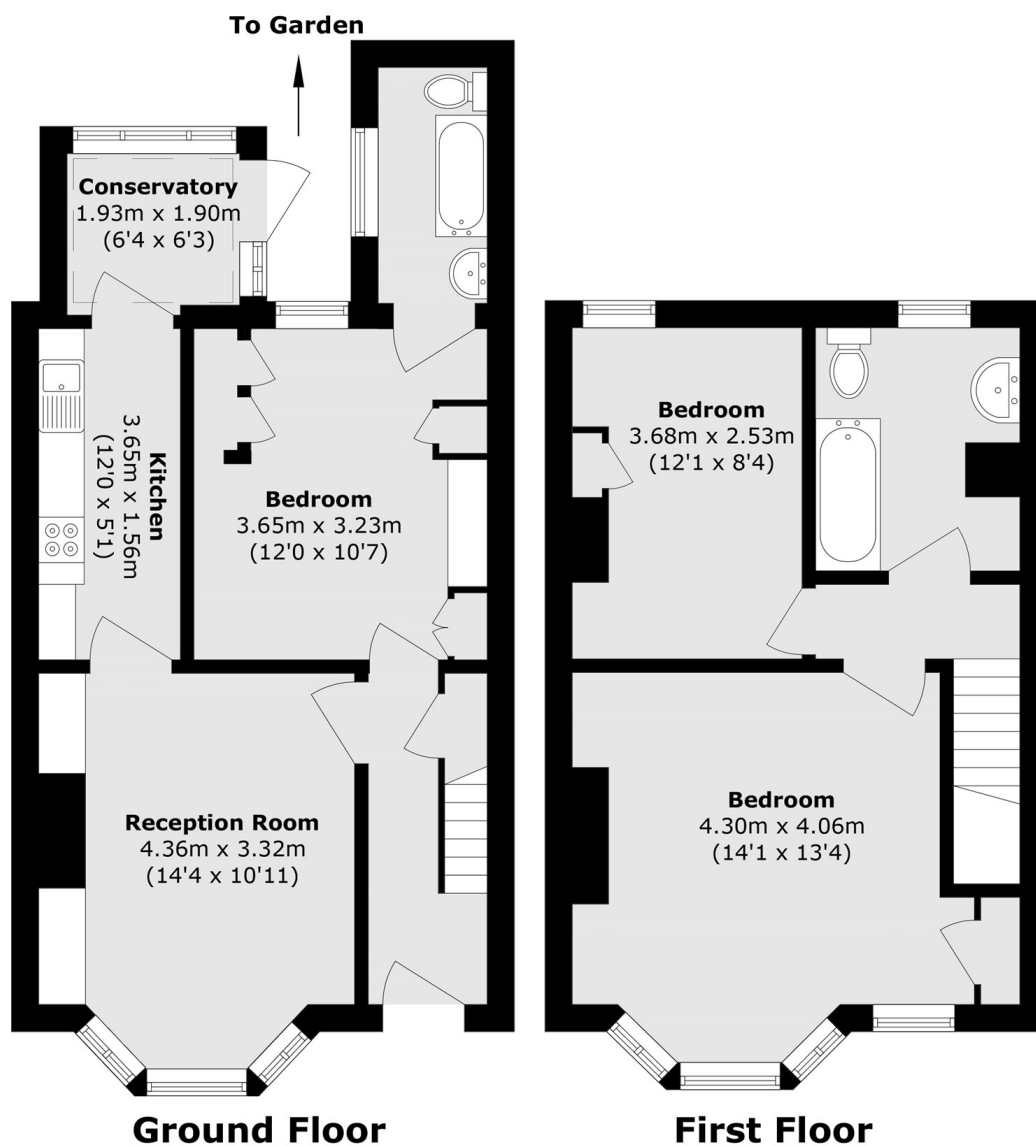

Total area (approx.): 83.0 sq. m (893.4 sq. ft)

## Dexters

St Margarets  
1 Chertsey Road  
St Margarets  
TW1 1LR  
Sales  
020 8744 9400

Energy Rating: F. We aim to make our particulars both accurate and reliable. However they are not guaranteed; nor do they form part of an offer or contract. If you require clarification on any points then please contact us, especially if you're traveling some distance to view. Please note that appliances and heating systems have not been tested and therefore no warranties can be given as to their good working order.

 **RICS** | Regulated  
Estate Agent  
and Letting Agent

[dexters.co.uk](https://www.dexters.co.uk)