



South Street, TW7

£2,150 Per calendar month

A contemporary two bedroom apartment in a sought-after village setting. Offering a bright open-plan living space, sleek modern kitchen, private balcony and two generous double bedrooms; this home is designed for comfort and style. With energy-efficient solar panels, you'll enjoy lower utility costs while living more sustainably.

South Street is in the heart of Old Isleworth within 0.2 miles of the River Thames and its tow path walks into Richmond. Within a mile of Twickenham Station and in the centre of the local amenities.

Features

- Two Double Bedrooms
- Modern Kitchen
- Solar Panels
- First Floor
- Village Location
- Private Balcony

South Street, Isleworth, TW7

First Floor

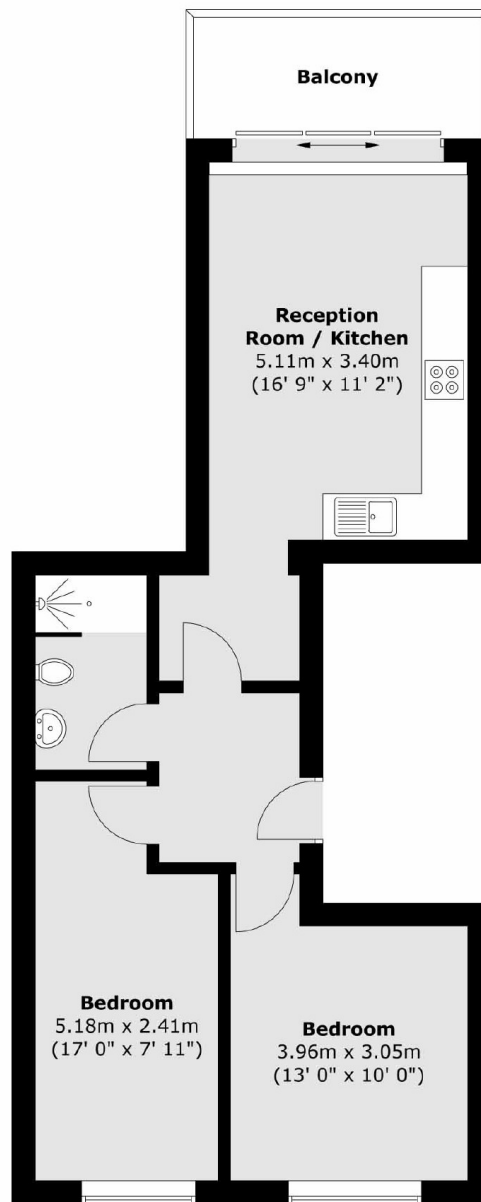

Total area (approx.) : 53.4 sq. m (575 sq. ft)
Total balcony area (approx.) : 5.2 sq. m (56 sq. ft)

Dexters

St Margarets
1 Chertsey Road
St Margarets
TW1 1LR
Lettings
020 8744 9700

Energy Rating: A. We aim to make our particulars both accurate and reliable. However they are not guaranteed; nor do they form part of an offer or contract. If you require clarification on any points then please contact us, especially if you're traveling some distance to view. Please note that appliances and heating systems have not been tested and therefore no warranties can be given as to their good working order.

 **RICS** | Regulated
Estate Agent
and Letting Agent

dexters.co.uk