



## Worple Road, TW7

### £808,000

This semi-detached three bedroom property presents an excellent opportunity to acquire a house that offers significant potential for further expansion to meet your evolving needs. Being brought to the market with the added benefit of no onward chain, this should allow for a smoother and potentially quicker transaction.

Worple Road is located in the heart of Old Isleworth, providing access to excellent schools, St Margarets village and train station. There is also access to the River Thames and Richmond Lock leading to Old Deer Park.

### Features

- No Onward Chain
- Semi-Detached
- Three Bedrooms
- Potential To Extend STPP
- Large Garden
- Fantastic Location





## Worple Road, TW7

The downstairs layout of the property is truly ideal for hosting, featuring a fully extended kitchen/living/dining space that creates a wonderful open area for entertaining. The bi-fold doors open onto a large west facing garden. Also on this floor is a bright and spacious separate reception room at the front of the house as well as a downstairs WC.

On the first floor there are two generously sized double bedrooms, as well as a comfortable single bedroom and large family bathroom. This house also allows for further extension through doing a loft conversion, which could provide a further bedroom as well as an en suite bathroom and significantly increase the living space of the property.



# Worple Road, Old Isleworth, TW7

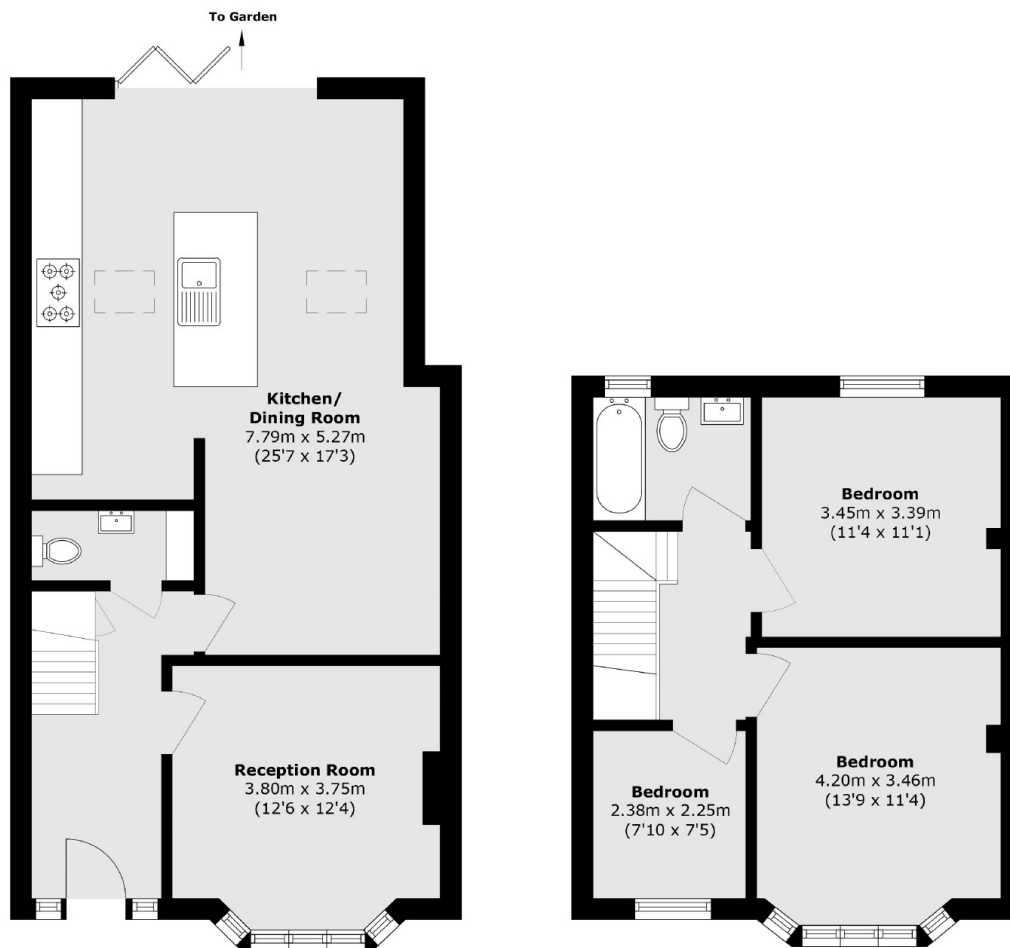

Total area (approx.): 106.3 sq. m (1144.2 sq. ft)

## Dexters

St Margarets  
1 Chertsey Road  
St Margarets  
TW1 1LR  
Sales  
020 8744 9400

Energy Rating: D. We aim to make our particulars both accurate and reliable. However they are not guaranteed; nor do they form part of an offer or contract. If you require clarification on any points then please contact us, especially if you're traveling some distance to view. Please note that appliances and heating systems have not been tested and therefore no warranties can be given as to their good working order.

 **RICS** | Regulated  
Estate Agent  
and Letting Agent

[dexters.co.uk](https://www.dexters.co.uk)