



St. Margarets Road, TW1

£1,850 Per calendar month

This newly redecorated top-floor flat offers two double bedrooms, a large bright living room, and a spacious kitchen. With tall windows allowing natural light to flood the space, the property also includes hot water. Additional benefits include a garage, non-allocated parking, and excellent transport links, all in the heart of St Margarets Village.

The Grove is just 0.2 miles from St Margarets Station and the vibrant high street with its cafes and boutique shops. The River Thames is also only 1 mile away.

Features

- Two Double Bedrooms
- New Carpets
- Excellent Transport Links
- Spacious Kitchen
- Newly Redecorated
- Garage Included

St. Margarets Road, London, TW1

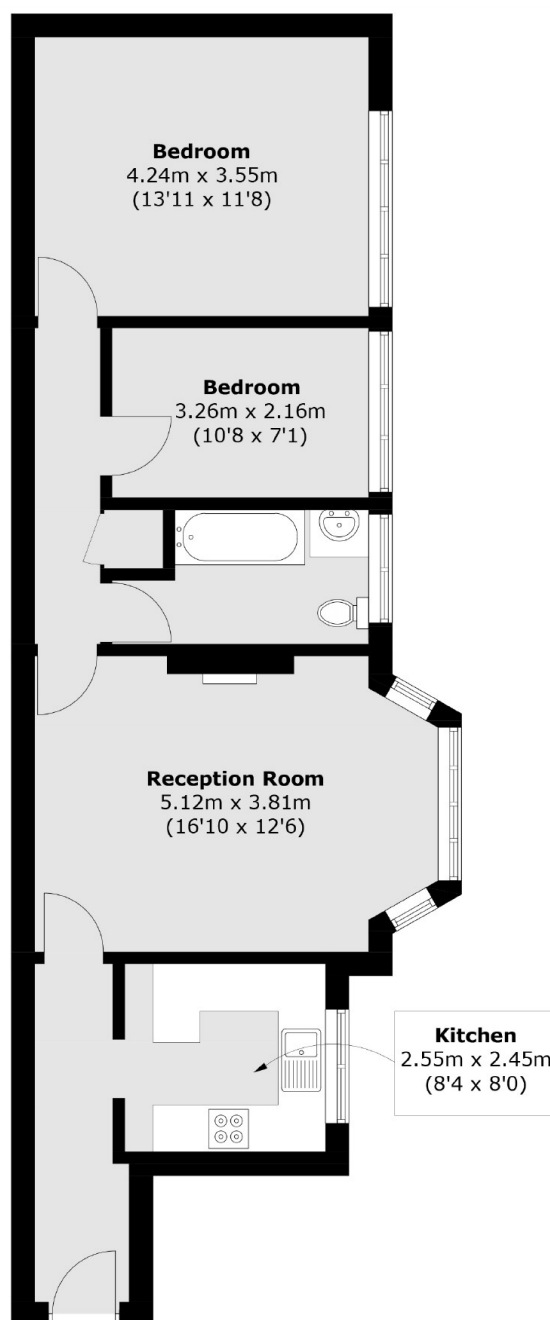

Total area (approx.): 63.3 sq. m (681.4 sq. ft)