



Rosslyn Road, TW1
£300,000

Dexters



Rosslyn Road, TW1

Situated in the heart of East Twickenham, is this charming and spacious one bedroom conversion apartment located on the ground floor of this grand Victorian building. Offered with no onward chain and the option to purchase a share of the freehold this property is not to be missed.

The period property offers a number of benefits including a private patio space, off-street parking and pretty original features.

Rosslyn Road is a premier road in East Twickenham just 0.2 miles of St Margarets village with its boutique shops, cafés and train station. Richmond Bridge and Richmond town centre are only 1 mile away with its popular shops, restaurants, fast overground service to London Waterloo and tube lines. Moor Mead Park, Marble Hill Park and the River Thames are also close by.

Features

- Victorian Conversion
- High Ceilings
- Central Location
- Ground Floor
- Large Reception Room
- Vacant Possession



Rosslyn Road, East Twickenham, TW1

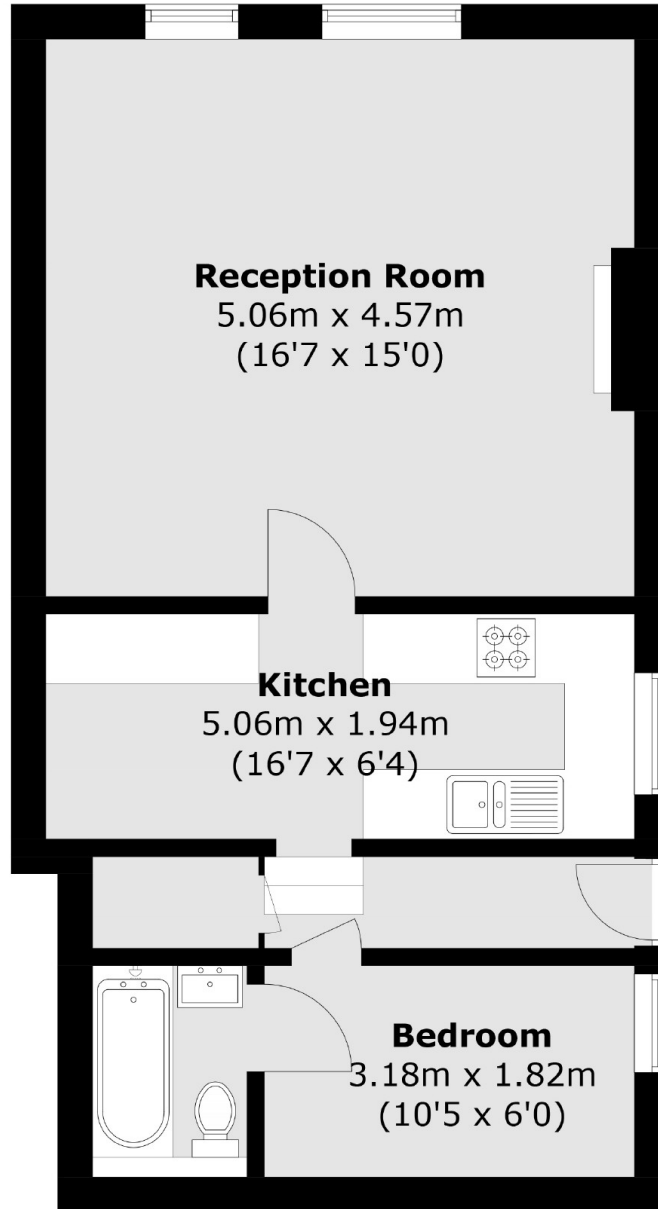

Total area (approx.): 48.5 sq. m (522.0 sq. ft)

Dexters

St Margarets
1 Chertsey Road
St Margarets
TW1 1LR
Sales
020 8744 9400

Energy Rating: C. We aim to make our particulars both accurate and reliable. However they are not guaranteed; nor do they form part of an offer or contract. If you require clarification on any points then please contact us, especially if you're traveling some distance to view. Please note that appliances and heating systems have not been tested and therefore no warranties can be given as to their good working order.

 **RICS** | Regulated
Estate Agent
and Letting Agent

[dexters.co.uk](https://www.dexters.co.uk)