



St. Margarets Road, TW1

£1,795 Per calendar month

A well presented and bright two bedroom top floor apartment, set within this impressive building in St Margarets. There is also an allocated parking space and communal gardens.

St Margarets is a popular location close to the River Thames and home to some beautiful period housing. With easy access to tow path walks along the river to Richmond.

Features

- Two Double Bedrooms
- Communal Rear Garden
- Allocated Parking Space
- Plenty Of Storage
- Victorian Conversion
- Modern Bathroom

St. Margarets Road, Twickenham, TW1

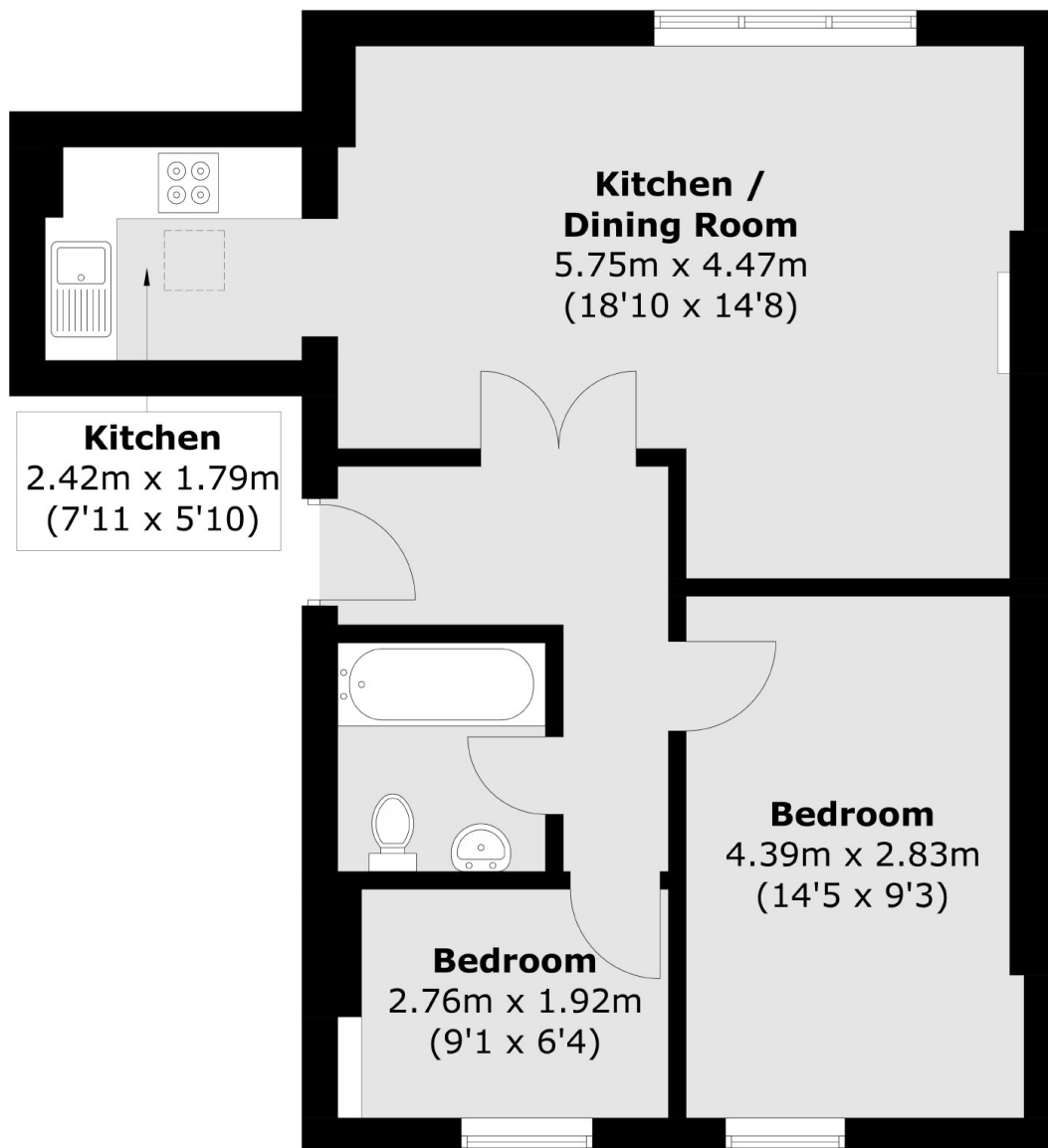

Total area (approx.): 56.3 sq. m (606.0 sq. ft)