



## St. Margarets Road, TW1

### £385,000

A well presented two double bedroom ground floor apartment located in the heart of St Margarets village. This spacious flat has access to a lovely communal garden, has a large reception room, a modern kitchen and non allocated parking. There is also no onward chain with the property.

The Grove is within 0.2 miles of St Margarets Station, the bustling high street with its cafes and boutique shops. It is also within 1.0 mile of the River Thames.

### Features

- Two Double Bedrooms
- Great Location
- Large Reception Room
- Modern Kitchen
- Non Allocated Parking
- No Chain

# St. Margarets Road, St Margarets, TW1

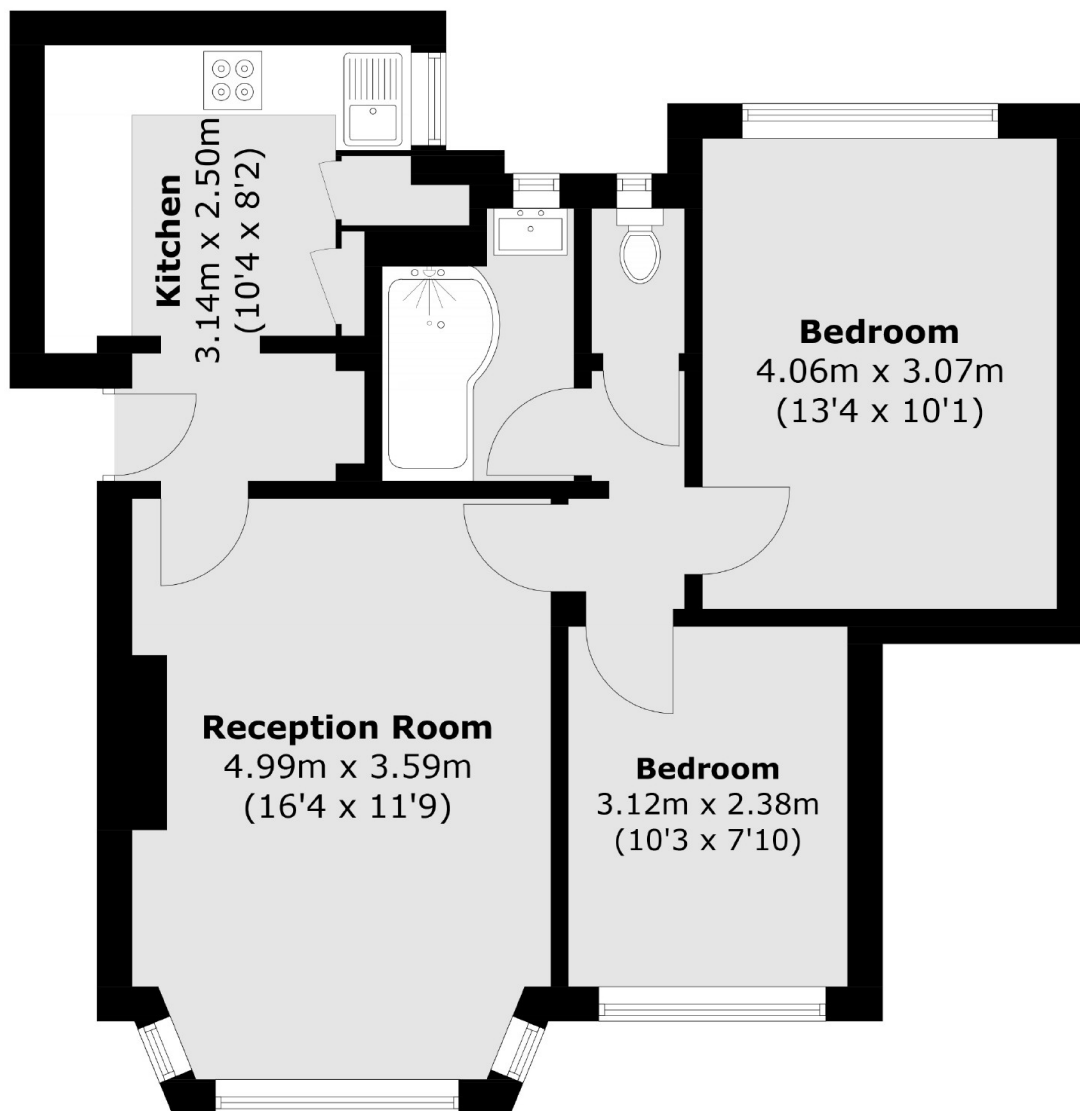

Total area (approx.): 57.0 sq. m (613.5 sq. ft)