



## St. Margarets Road, TW1

£579,950

A bright and spacious ground floor apartment located in the heart of St Margarets Village. This wonderful property has a large bay fronted reception room, eat in kitchen and three double bedrooms. To the rear of the property is an enclosed communal garden and there is unallocated parking to the front. This fantastic property comes with no onward chain and is not to be missed.

The Grove is within 0.2 miles of St Margarets Station, the bustling high street with its cafes and boutique shops. Moormead Park, Marble Hill Park and the River Thames are also close by.

### Features

- Three Double Bedrooms
- Great Location
- Large Reception Room
- Non Allocated Parking
- Communal Gardens
- No Onward Chain

# St. Margarets Road, St Margarets, TW1

## Ground Floor

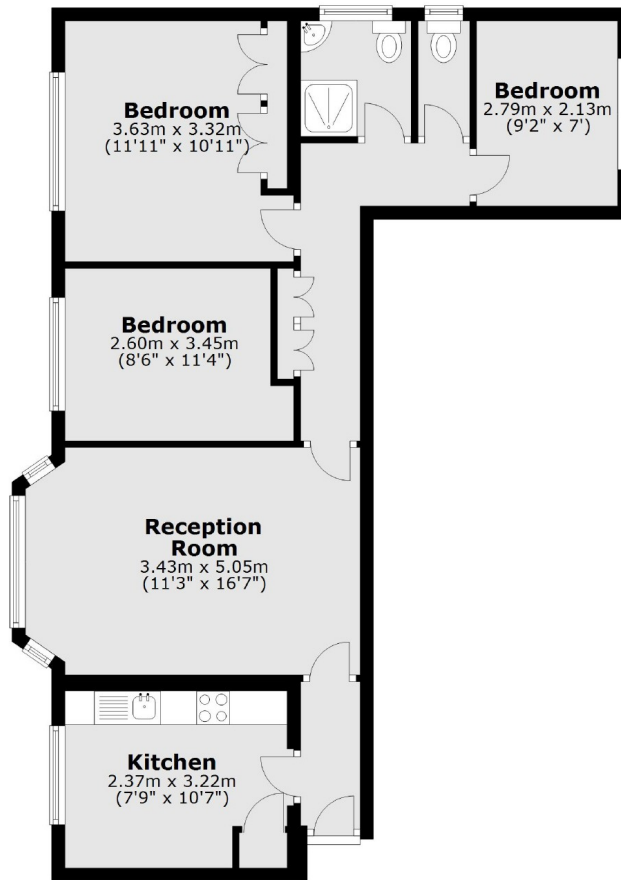

Total area: approx. 68.6 sq. metres (738.1 sq. feet)