



Queens Terrace, TW7

£545,000

This delightful two double bedroom Victorian cottage benefits from an upstairs bathroom, spacious double reception room, modern fitted kitchen and a private secluded south-facing courtyard garden. The property has potential to convert the loft subject to the usual consents.

Queens Terrace is a quiet cul-de-sac conveniently location in the heart of Old Isleworth close to local schools and shops. The property is also within half a mile of the River Thames with its tow path walks to Richmond and within a mile of St. Margarets village and mainline station.

Features

Victorian Cottage
Beautifully Refurbished
Two Reception Rooms
Two Double Bedrooms
South-Facing Garden
Potential To Extend



Queens Terrace, TW7



Queens Terrace, Old Isleworth, TW7

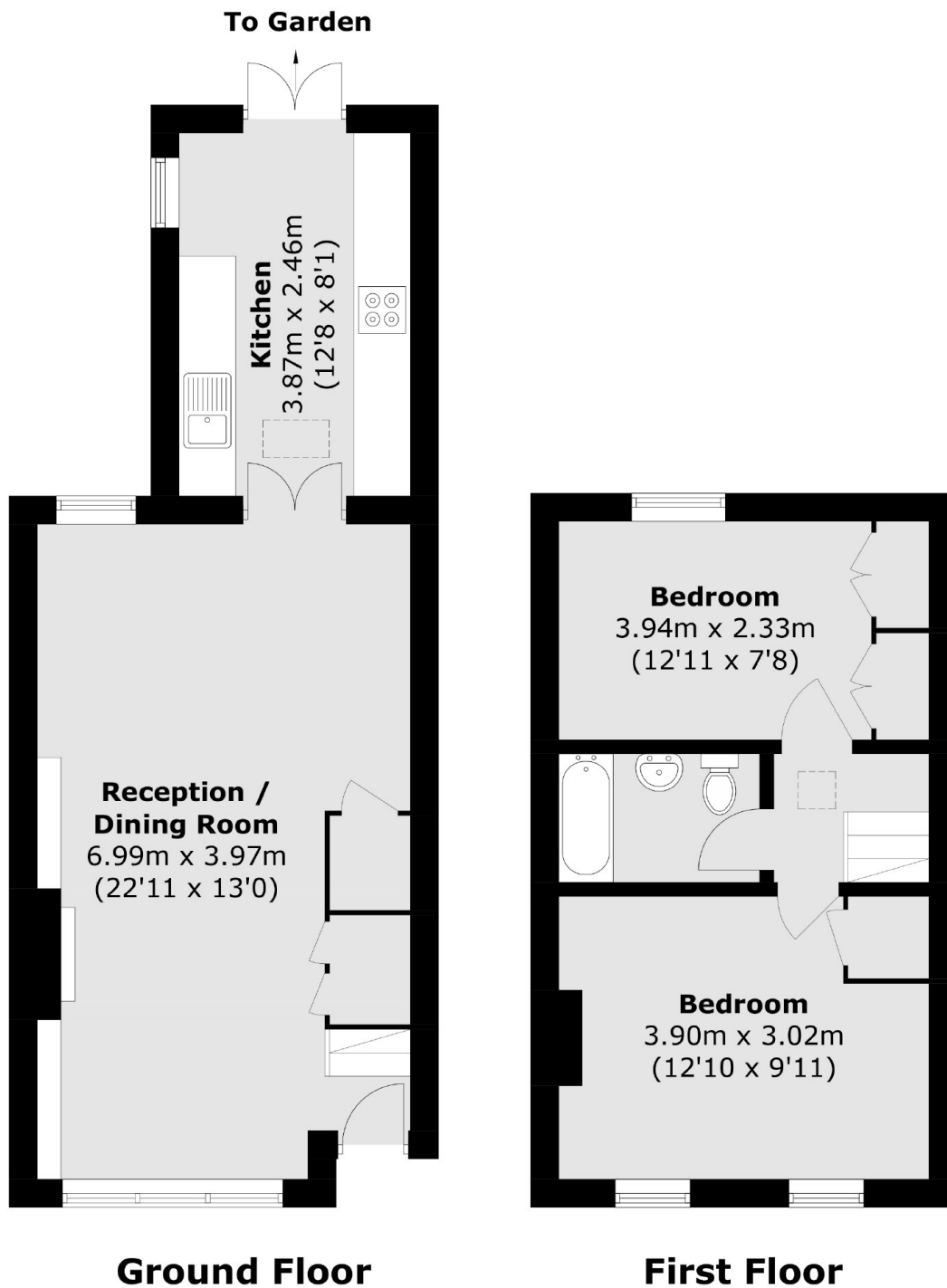

Total area (approx.): 65.3 sq. m (702.9 sq. ft)