



Cambridge Park, TW1

£425,000

Dexters



Cambridge Park, TW1

Situated in the sought after Cambridge Park conservation area, this one-bedroom top floor flat is minutes from the River Thames and surrounding parklands. The spacious open-plan reception room overlooks a peaceful private balcony, perfect for entertaining on a summer's day. The property also benefits from a a separate galley kitchen, a long lease, a garage and no chain.

Cambridge Park is idyllic, tucked away from East Twickenham high street but conveniently located near bustling Richmond town centre, St Margarets village and station. The area is also directly accessible to central London via St Margarets.

Features

- One Bedroom
- Top Floor Apartment
- Lovely Condition
- Private Balcony
- Long Lease
- Garage



Cambridge Park, East Twickenham, TW1

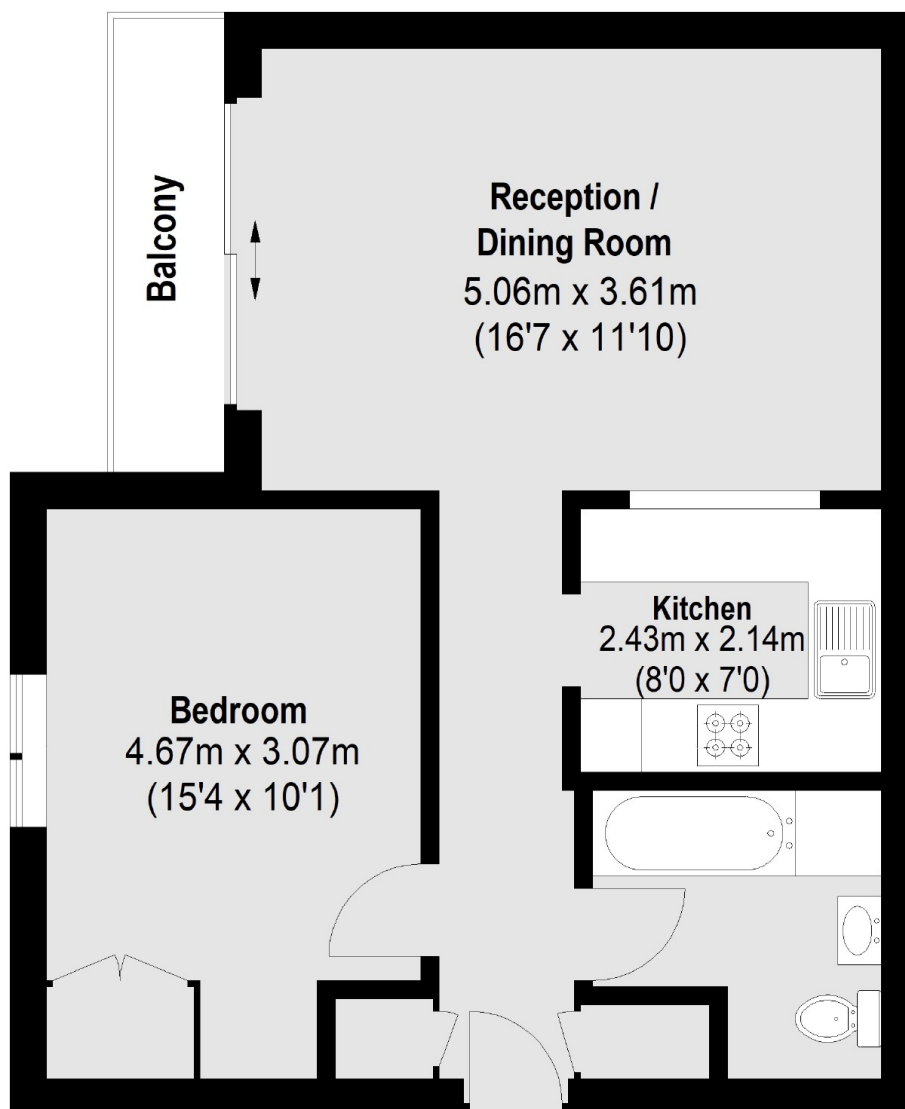

Total area (approx.): 51.24 sq. m (551 Sq. ft)
Balcony: 3.33 sq. m (36 Sq. ft)