



Winchester Road, TW1

£599,950

This charming Edwardian ground floor maisonette comes with two double bedrooms, a large reception room, a modern fitted kitchen with doors leading onto a west-facing private garden. The property is offered with no onward chain.

Winchester Road is popular residential road in the heart of St. Margarets Village, perfectly located for easy access to a choice of excellent schools, shops, cafés and mainline train station.

Features

- Ground Floor
- Two Double Bedrooms
- Private Garden
- High Ceilings
- Long Lease
- No Chain

Winchester Road, St Margarets, TW1

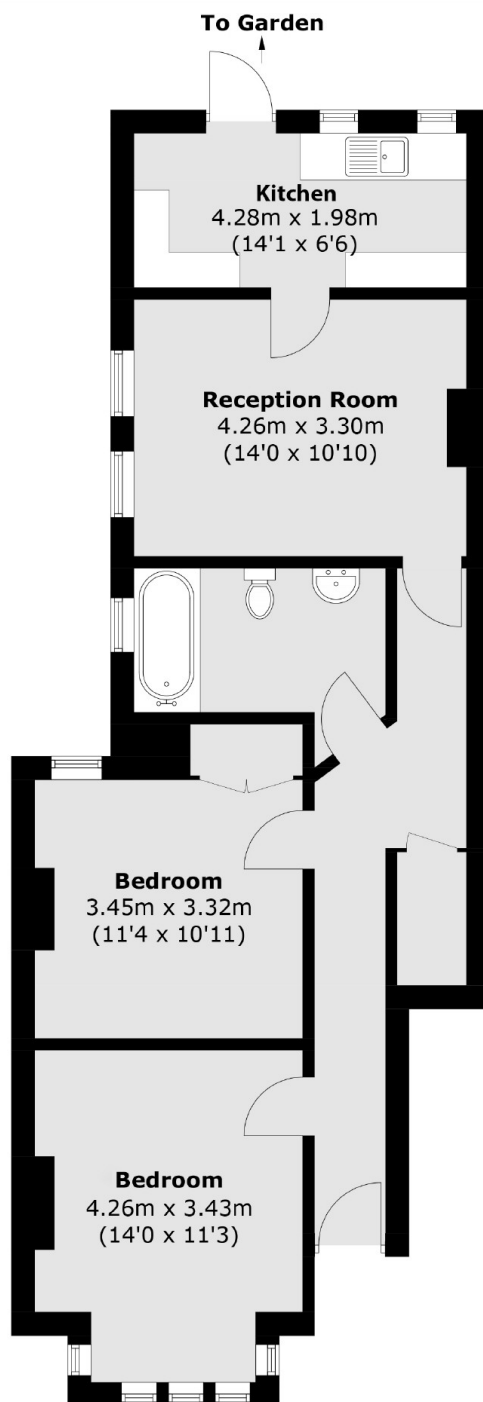

Total area (approx.): 69.8 sq. m (751.3 sq. ft)