



## Lawrence Parade, TW7

£349,950

A large one double bedroom first floor apartment situated in Lower Square. With no onward chain, the river within walking distance of the property and great school catchments this property is not to be missed out on.

Lawrence Parade is in the heart of Old Isleworth within 280 ft of the River Thames and its tow path walks into Richmond. Richmond has a variety of shops, restaurants and a train station. St Margarets village is 1.1 miles away.

### Features

- Two Bedrooms
- No Onward Chain
- Balcony
- Views Over The Green
- Close To The River
- Nicely Presented

# Lawrence Parade, Old Isleworth, TW7

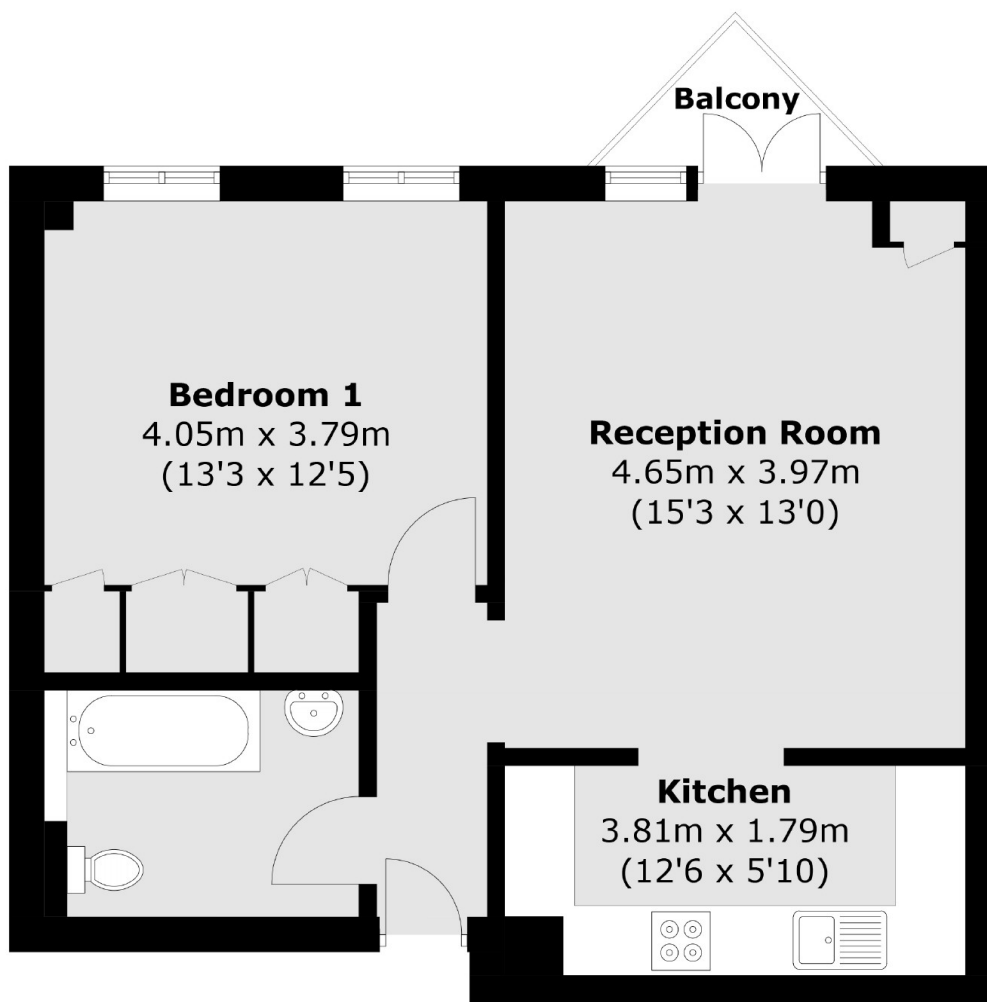

Total area (approx.): 51.0 sq. m (549.0 sq. ft)  
Balcony : 1.5 sq. m (16.1 sq. ft)