



Elizabeth Gardens, TW7

£1,395 Per calendar month

A bright and well presented one bedroom apartment situated in a private gated crescent with allocated parking. The flat is perfectly suited to a single occupant or couple.

Within half a mile of Richmond Lock and St Margarets Village including its mainline train station and village High Street with popular boutique shops, restaurants and cafes.

Features

- Gated Development
- Open Plan Living
- One Double Bedroom
- Modern Bathroom
- Communal Gardens
- Allocated Parking

Elizabeth Gardens, Old Isleworth, TW7

Second Floor

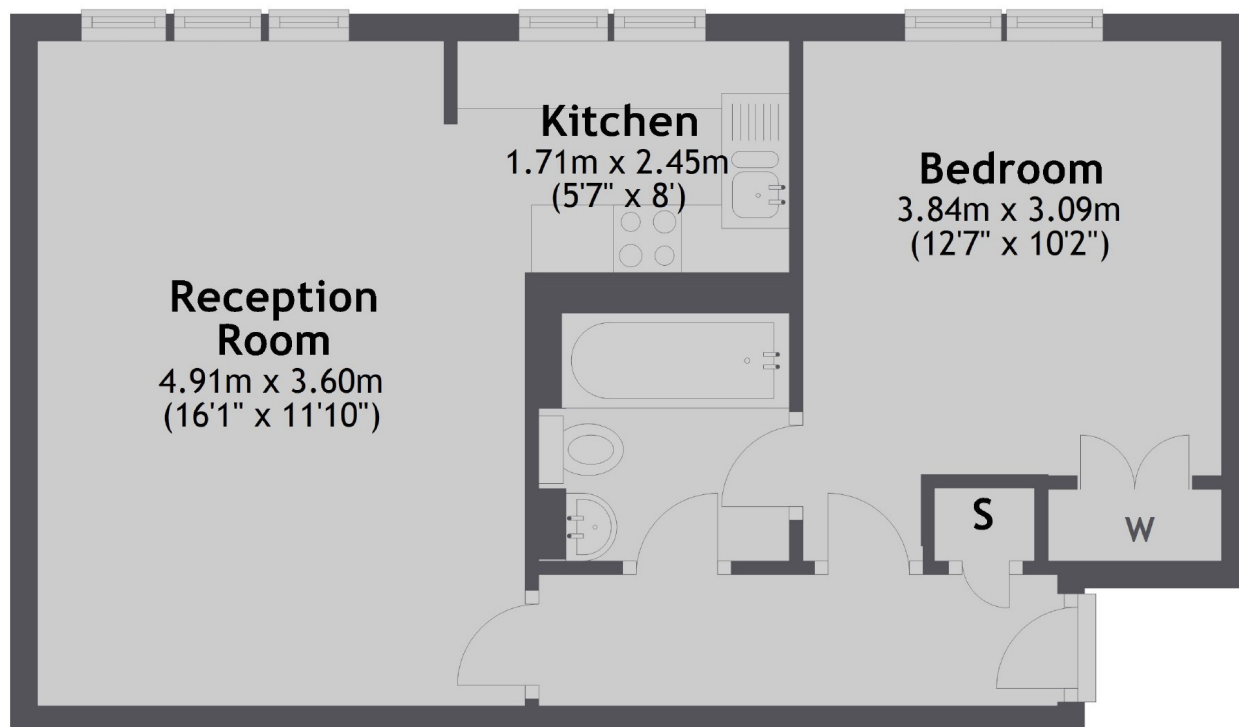

Total area: approx. 41.6 sq. metres (447.8 sq. feet)