



## Richmond Road, TW1

£325,000

This fantastic one bedroom first floor Victorian conversion flat is perfectly located for both Richmond and St. Margarets town centres. With plenty of pubs, bars and restaurants on your door step as well as excellent transport links. The property offers one double bedroom, a bright reception room, a fitted kitchen, a bathroom and is in good condition throughout. With no onward chain, this property is not to be missed.

Located on Richmond Road in East Twickenham everything is close by. From shops, the River Thames, Marble Hill Park, St. Margarets Village, Richmond town centre and respective train stations. Richmond Station benefits from tube connections and fast trains to London Waterloo.

### Features

- One Double Bedroom
- Central Location
- No Onward Chain
- 104 Year Lease
- Transport Links
- Close to Marble Hill Park

# Richmond Road, East Twickenham, TW1

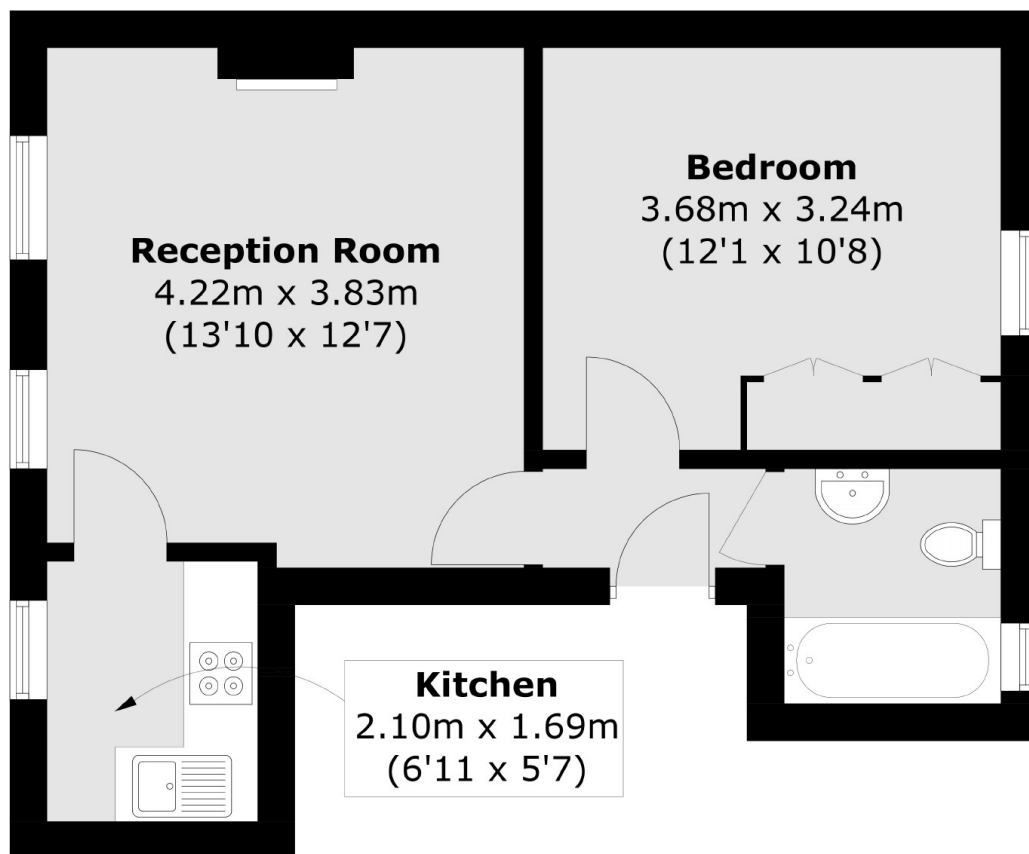

Total area (approx.): 37.9 sq. m (407.9 sq. ft)