



St. Margarets Road, TW1

£449,950

Set within this handsome Victorian building, is this newly refurbished one double bedroom ground floor garden flat. We love the spacious rooms with high ceilings and the tasteful decor throughout. Offered with off-street parking, and no onward chain this property is not to be missed.

This property is conveniently positioned within a quarter mile from St. Margarets village with its mainline train station, shops, cafés and restaurants. The River Thames is nearby, you will enjoy the towpath walk into Richmond town centre.

Features

- Share Of Freehold
- Open-Plan Living/Kitchen
- Large Double Bedroom
- Stylish Bathroom
- Off-Street Parking
- Private Garden

St. Margarets Road, St Margarets, TW1

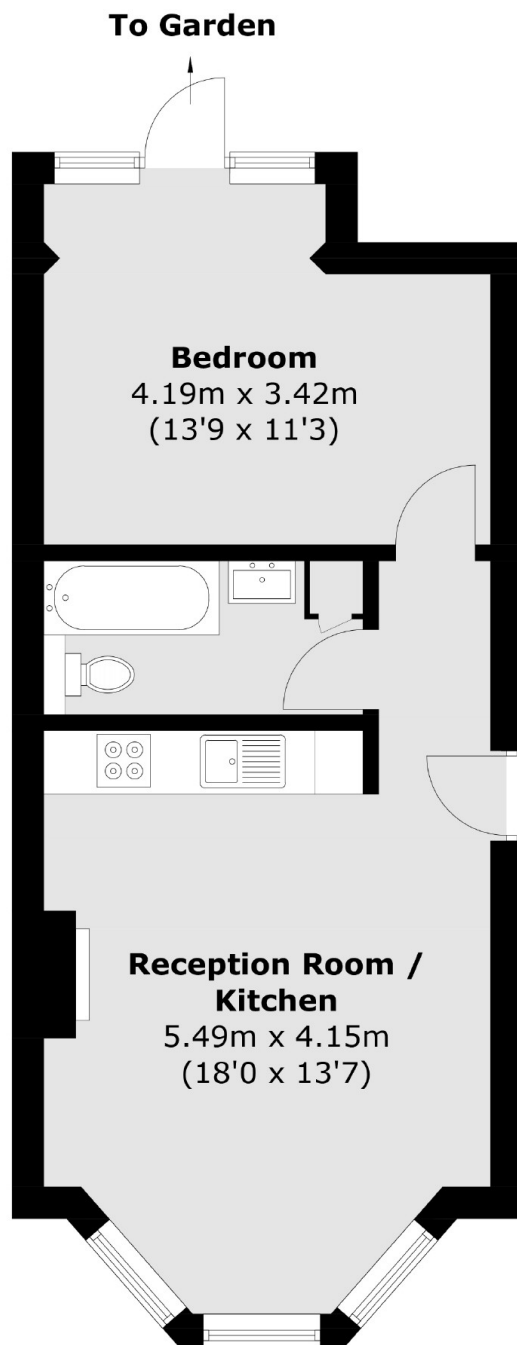

Total area (approx.): 41.4 sq. m (445.6 sq. ft)