



Chertsey Road, TW1

£429,950

Set within a stylish Art Deco development, is this lovely two double bedroom ground floor flat. With direct access onto a private terrace leading onto the communal gardens, the flat is offered in excellent condition throughout and with a newly extended lease upon completion.

Cavendish House is within 0.4 miles of St Margarets village and mainline station. Within 0.6 miles from Twickenham high street and mainline station.

Features

- Art Deco Development
- Two Double Bedrooms
- Rentable Parking
- Ground Floor
- Private Outside Space
- Newly Extended Lease

Chertsey Road, St Margarets, TW1

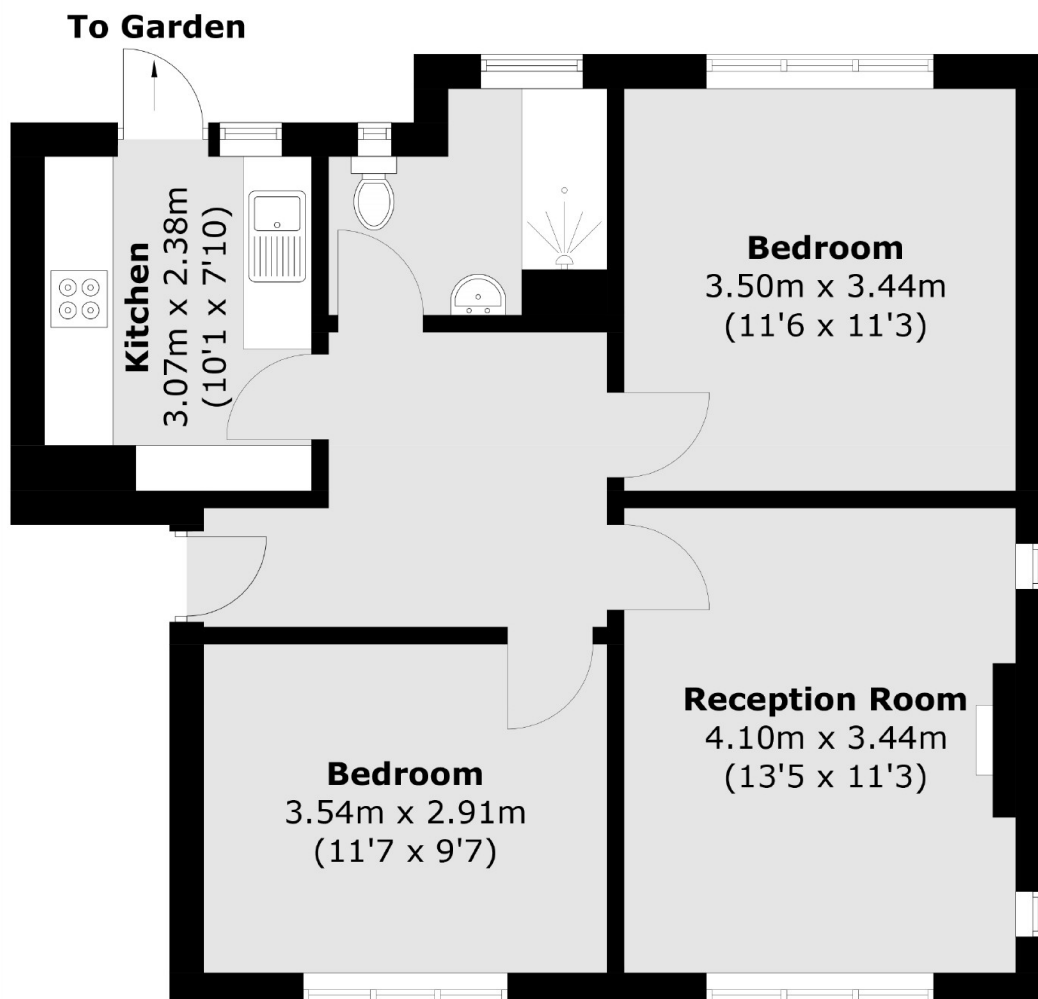

Total area (approx.): 58.8 sq. m (632.9 sq. ft)