



Heron Road, TW1

£935,000

A beautiful four bedroom period property offered to the market with scope to extend STPP. With plenty of character throughout this property is not to be missed.

Heron Road is a tree lined residential Road in St Margarets 0.3 miles from the River Thames and its tow path walks into Richmond and 0.6 miles from St Margarets village high street.

Features

- Period Property
- Four Bedrooms
- Potential To Extend STPP
- Fantastic Location
- Period Features
- Secluded Garden



Heron Road, TW1

Enter on the ground floor and there is a double through reception room at the front with a large bay window. At the rear of the house there is a kitchen which still has scope to extend STPP.

On the first floor there are three double bedrooms and a modern family bathroom. There is a large master bedroom on the top floor. The garden is mainly laid to lawn with mature shrubbery.



Heron Road, St Margarets, TW1

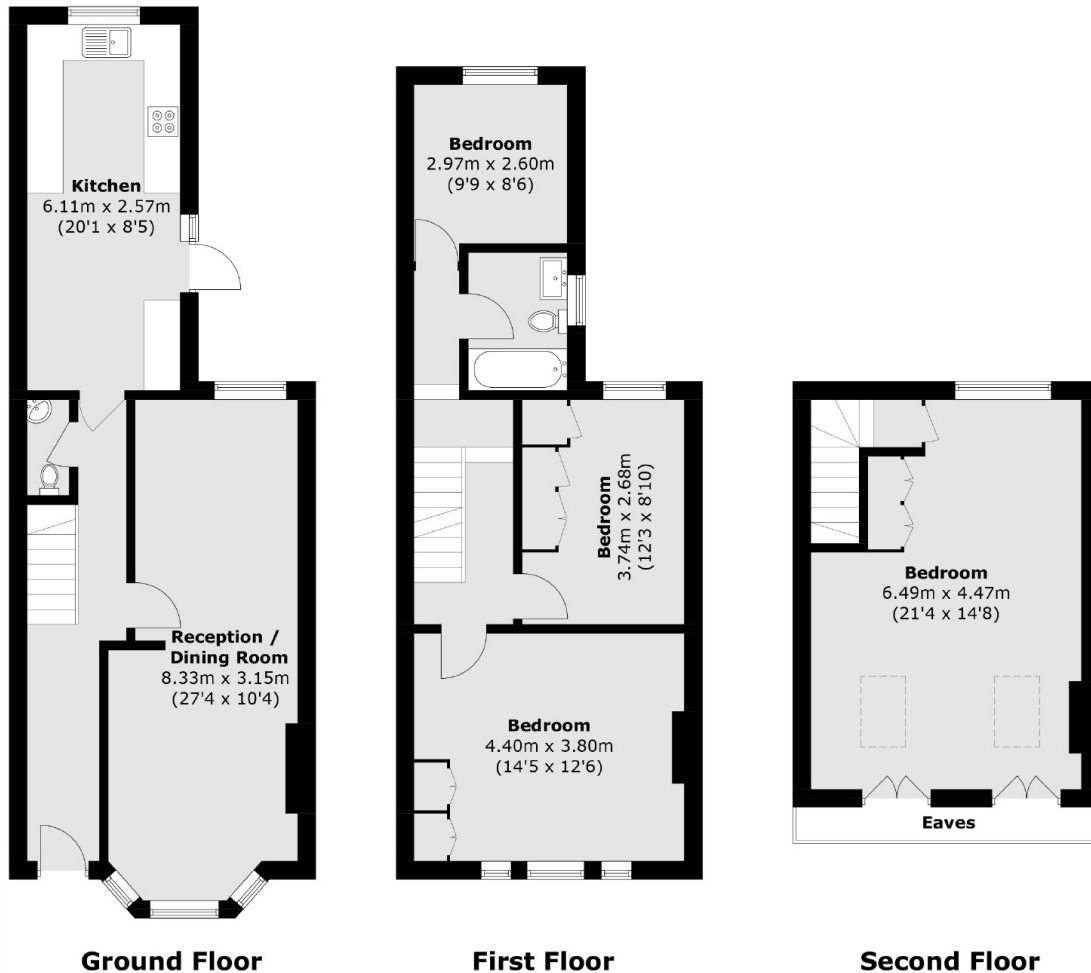

Total area (approx.): 129.7 sq. m (1396.1 sq. ft)
(Excluding Eaves)