



Clifford Road, TW10

£4,500 Per calendar month

Dexters



Clifford Road, TW10

A tastefully refurbished four bedroom house offering flexible living throughout. Perfectly positioned for local schools and ready to move, this property is perfect for a family.

On the ground floor offers there is a large double reception room which leads onto the conservatory and a newly turfed garden, with the added bonus of a separate laundry room. The brand new kitchen has been fitted with high specification appliances and a solid oak worktop.

On the first floor, there are two double bedrooms and a further single bedroom and brand new family bathroom. The top floor has another large bedroom and separate newly fitted shower room.

Clifford Road is a quiet residential road in Petersham, close to local amenities, Richmond Park and The River Thames. The house is also within close proximity of many popular local schools and a short distance into Richmond town centre.

Features

- Four Bedrooms
- Newly Refurbished
- Modern Kitchen
- Landscaped Garden
- Bright & Spacious
- Great Catchment Area







Clifford Road, Richmond, TW10

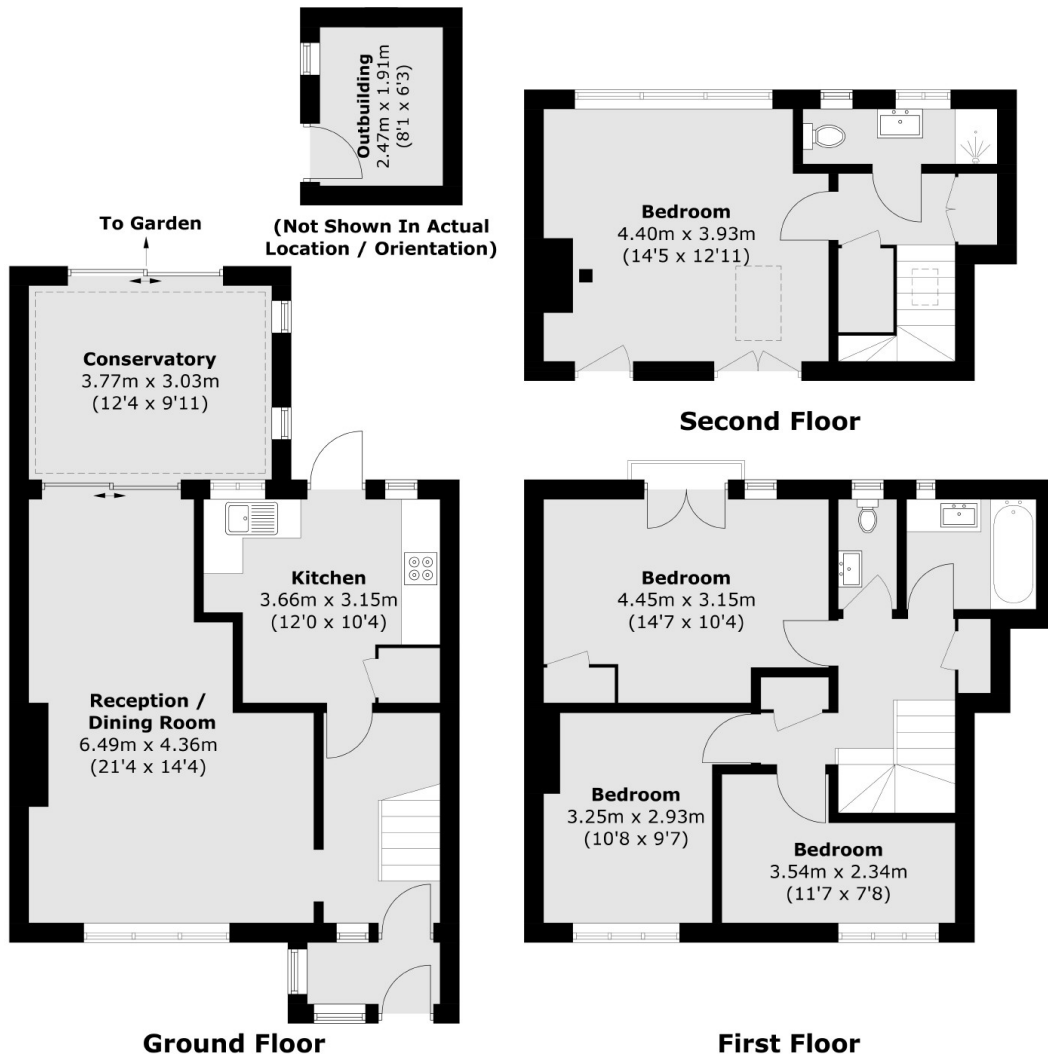

Total area (approx.): 128.2 sq. m (1,379.9 sq. ft)
Outbuilding (approx.): 4.8 sq. m (51.7 sq. ft)