



Sheendale Road, TW9

£1,495 Per calendar month

Set on a popular residential road is this Victorian one bedroom apartment in Richmond moments from the High Street Shops and station. The property is neutrally decorated with an abundance of natural light.

Sheendale Road is ideally located for the amenities of Richmond town centre, with Richmond Park, Richmond Hill and Richmond Riverside all being close by. Richmond train station offers access to and from London by tube, rail via the District line or South West trains.

Features

- Wooden Floors
- Double Bedroom
- Shared Garden
- Ample Storage
- First Floor
- Neutral Decor

Sheendale Road, Richmond, TW9

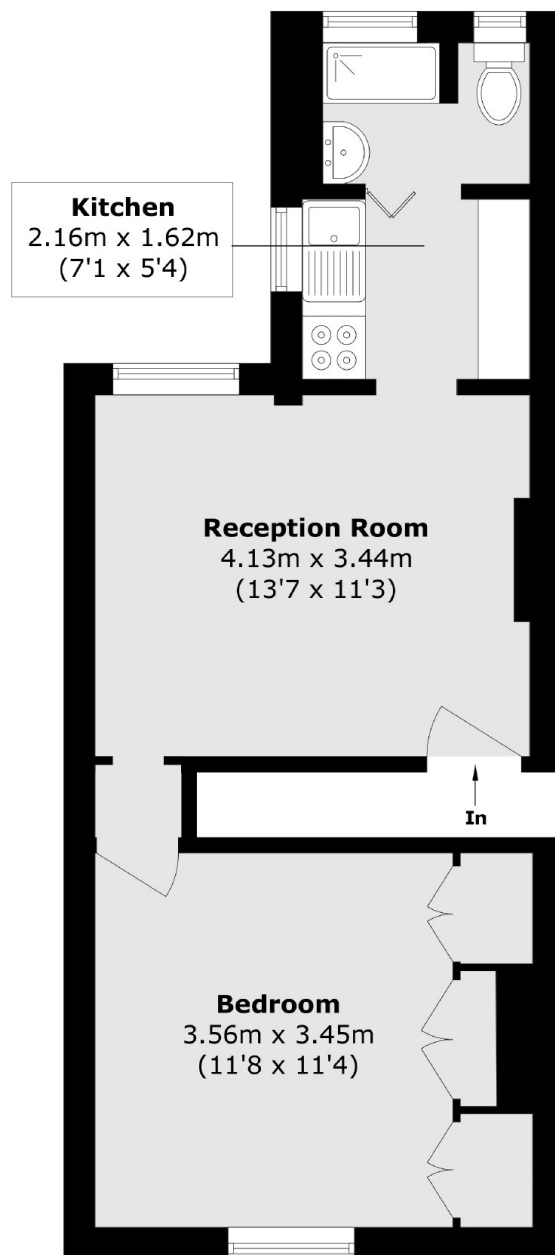

Total area (approx.): 37.0 sq. m (398.2 sq. ft)