



## Lower Grove Road, TW10

**£4,000** Per calendar month

An opportunity to rent a well-presented four bedroom family home situated on a quiet road on the lower slopes of Richmond Hill, offering 1445 sq ft of accommodation.

Ideally located close to local amenities, highly regarded schools, and excellent transport links, this property offers a convenient and comfortable lifestyle. It's the perfect forever home for families seeking space, functionality, and great transport links.

### Features

- Four Bedrooms
- End of Terrace
- Modern Kitchen
- Garden
- Off Street Parking
- Great School Nearby



## Lower Grove Road, TW10

This spacious four-bedroom family home offers modern living throughout. The well-equipped kitchen provides ample storage and generous worktop space, ideal for everyday cooking and entertaining. A large reception room with wood flooring and abundant natural light opens through double doors onto a private patio garden, perfect for outdoor dining and relaxation.

The property features four well-proportioned bedrooms. The master bedroom includes fitted wardrobes and a stylish en-suite bathroom. A contemporary family bathroom serves the additional bedrooms.





# Lower Grove Road, Richmond, TW10

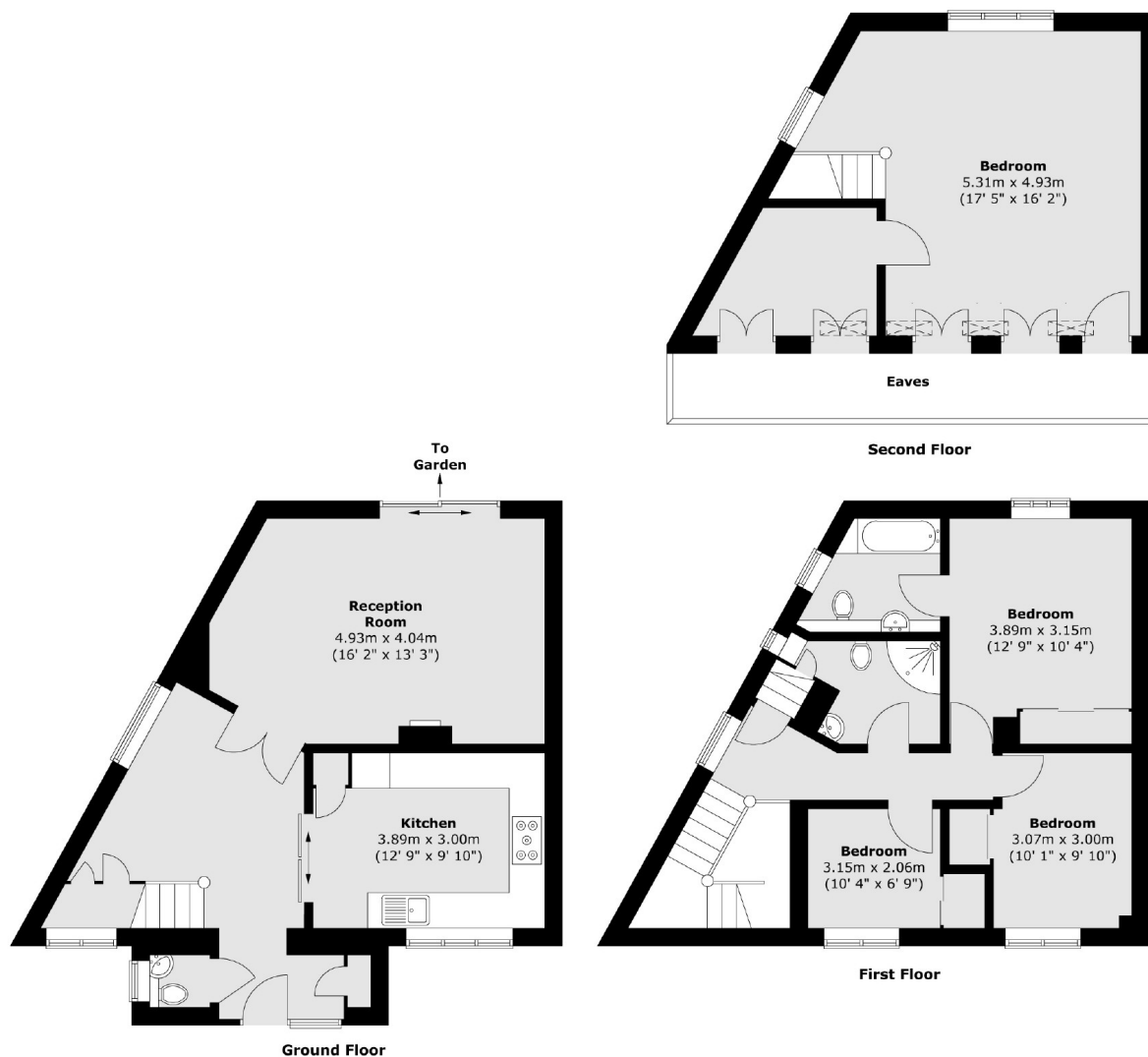

Total area (approx.) : 134.3 sq. m (1445 sq. ft)  
(Excluding eaves)