



The Hermitage, TW10

£2,095 Per calendar month

An immaculate two bedroom Edwardian conversion in the heart of Richmond. The living room has double height windows allowing an abundance of natural light flood into the property as well as wooden floors throughout and modern bathroom.

St Kilda is tucked away off the slopes of Richmond Hill moments from the action with great cafés, shops and restaurants all close by. If you are after somewhere close Richmond Park and the Terrace Gardens.

Features

- Two Bedrooms
- Central Location
- Wooden Floors
- Period Property
- Modern Bathroom
- Galley Kitchen

The Hermitage, Richmond, TW10

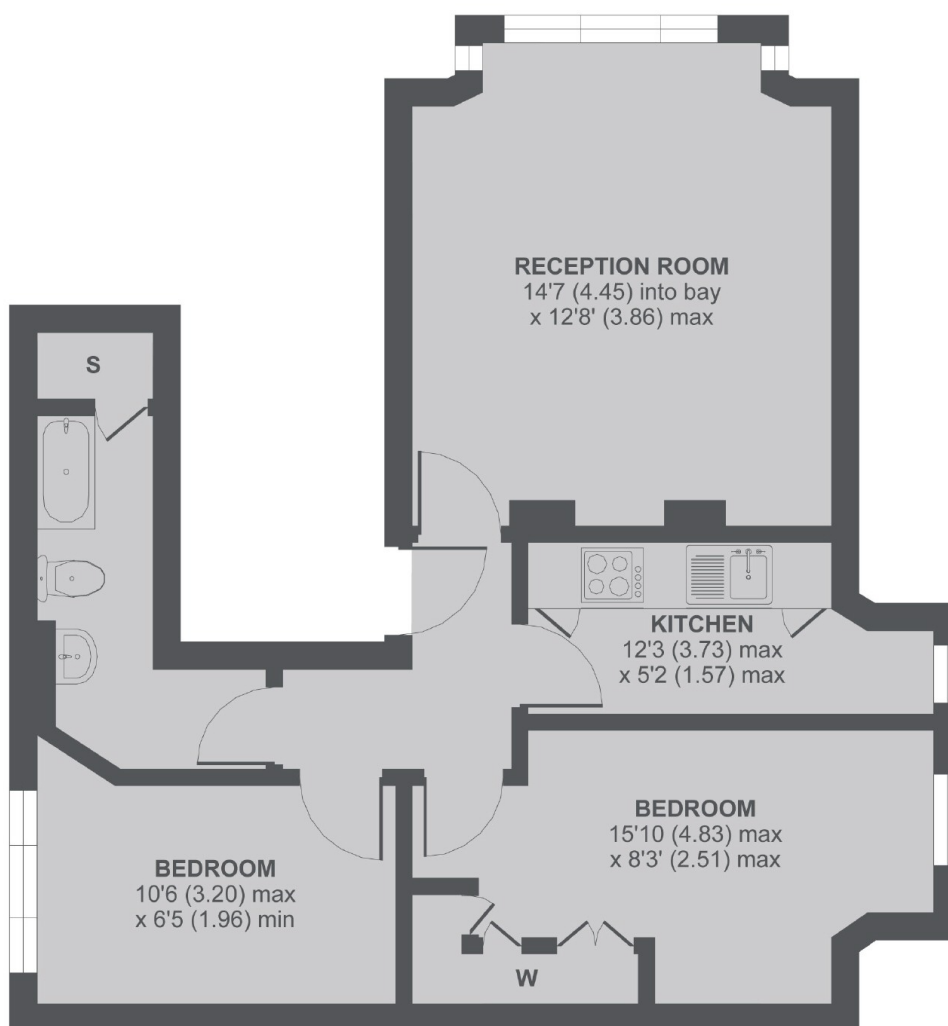

Raised Ground Floor

The Hermitage TW10

MAIN HOUSE APPROX FLOOR AREA 536 SQ.FT 549.7 SQ.M

Copyright nichecom.co.uk 2018 REF : 280335

Dexters

Richmond
1 Sheen Road
Richmond
TW9 1AD
Lettings
020 8288 0828

Energy Rating: E. We aim to make our particulars both accurate and reliable. However they are not guaranteed; nor do they form part of an offer or contract. If you require clarification on any points then please contact us, especially if you're traveling some distance to view. Please note that appliances and heating systems have not been tested and therefore no warranties can be given as to their good working order.

 **RICS** | Regulated
Estate Agent
and Letting Agent

dexters.co.uk