



The Vineyard, TW10

£4,995 Per calendar month

Dexters



The Vineyard, TW10

A pretty three-bedroom Victorian house located on the slopes of Richmond Hill. Recently re-painted, re-carpeted, and featuring a brand new kitchen, this is a perfect family home.

The ground floor accommodation consists of an entrance hall, a bay fronted double reception room with a feature fireplace and french doors leading to the rear garden and a fitted kitchen/dining room with door leading to the rear garden.

The first floor accommodation consists of a landing, a spacious bay fronted master double bedroom with a feature fireplace, a further double bedroom with a feature fireplace, a large single bedroom and a modern family bathroom. Outside to the front is a small garden. To the rear is a south facing garden enclosed by a brick wall and wooden panel fencing with a block paved patio with raised flower and shrub displays.

Located on The Vineyard within the heart of Richmond, the property is well located for the amenities on Richmond Hill, with Richmond Park, Richmond Riverside and Richmond town centre all being close by. Richmond train station offers access to and from London by rail or tube via the District line, South West trains and the London Overground service.

Features

- Three Bedrooms
- Brand New Kitchen
- Premier Location
- Double Reception Room
- South Facing Garden
- Excellent Condition







The Vineyard, Richmond, TW10

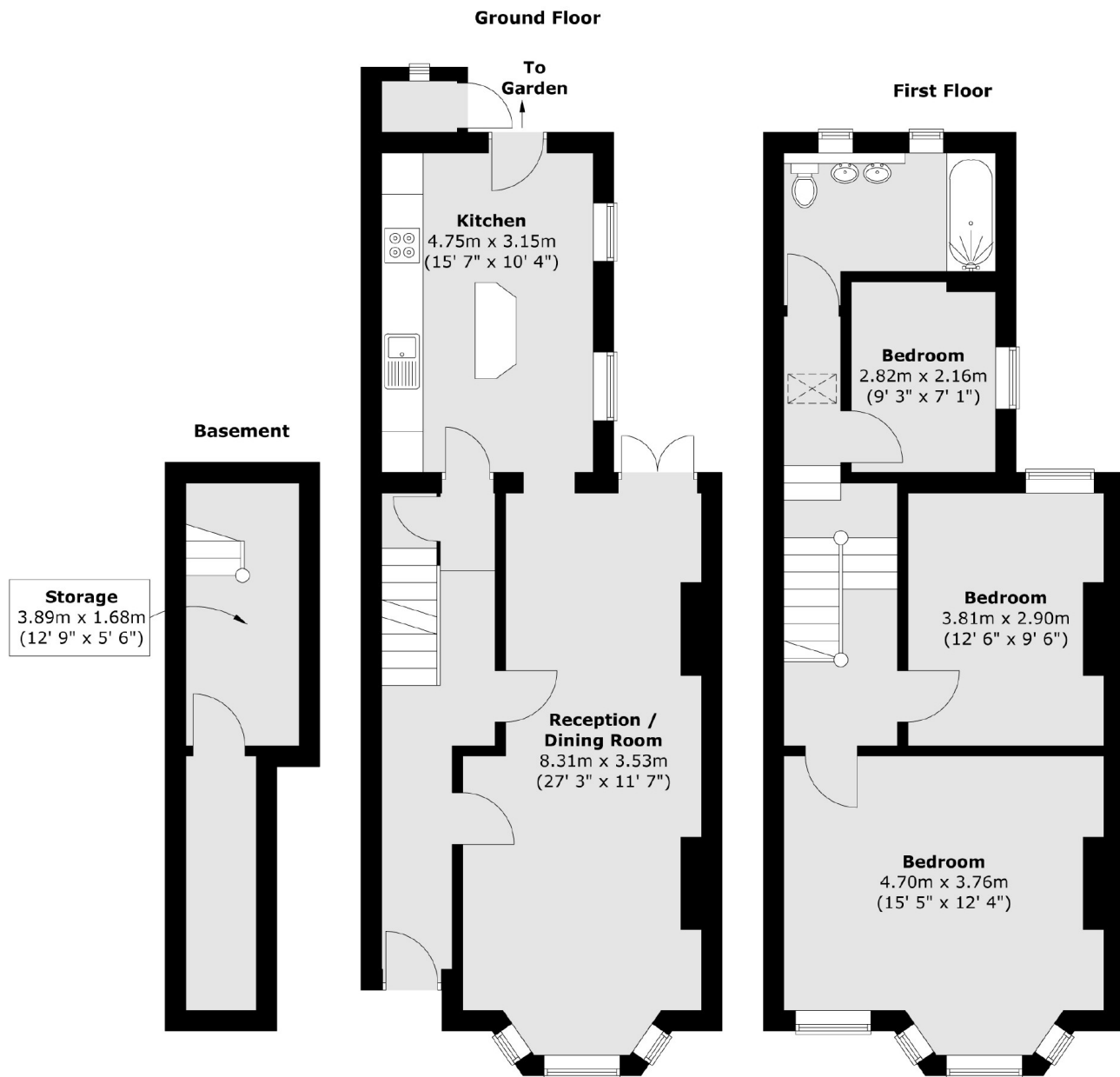

Total area (approx.) : 116.6 sq. m (1255 sq. ft)