



Manor Grove, TW9

£2,300 Per calendar month

Two bedroom cottage in North Sheen with a large garden. The property is presented in good condition throughout and has a through reception room, separate kitchen, two double bedrooms and large garden to the rear.

Manor Grove is only moments from North Sheen Station and a short distance into central Richmond with its wide array of shops, bars, restaurants and open green areas.

Features

- Two Double Bedrooms
- Cottage
- Private Garden
- Good Condition
- Wood Floors
- Modern Kitchen

Manor Grove, Richmond, TW9

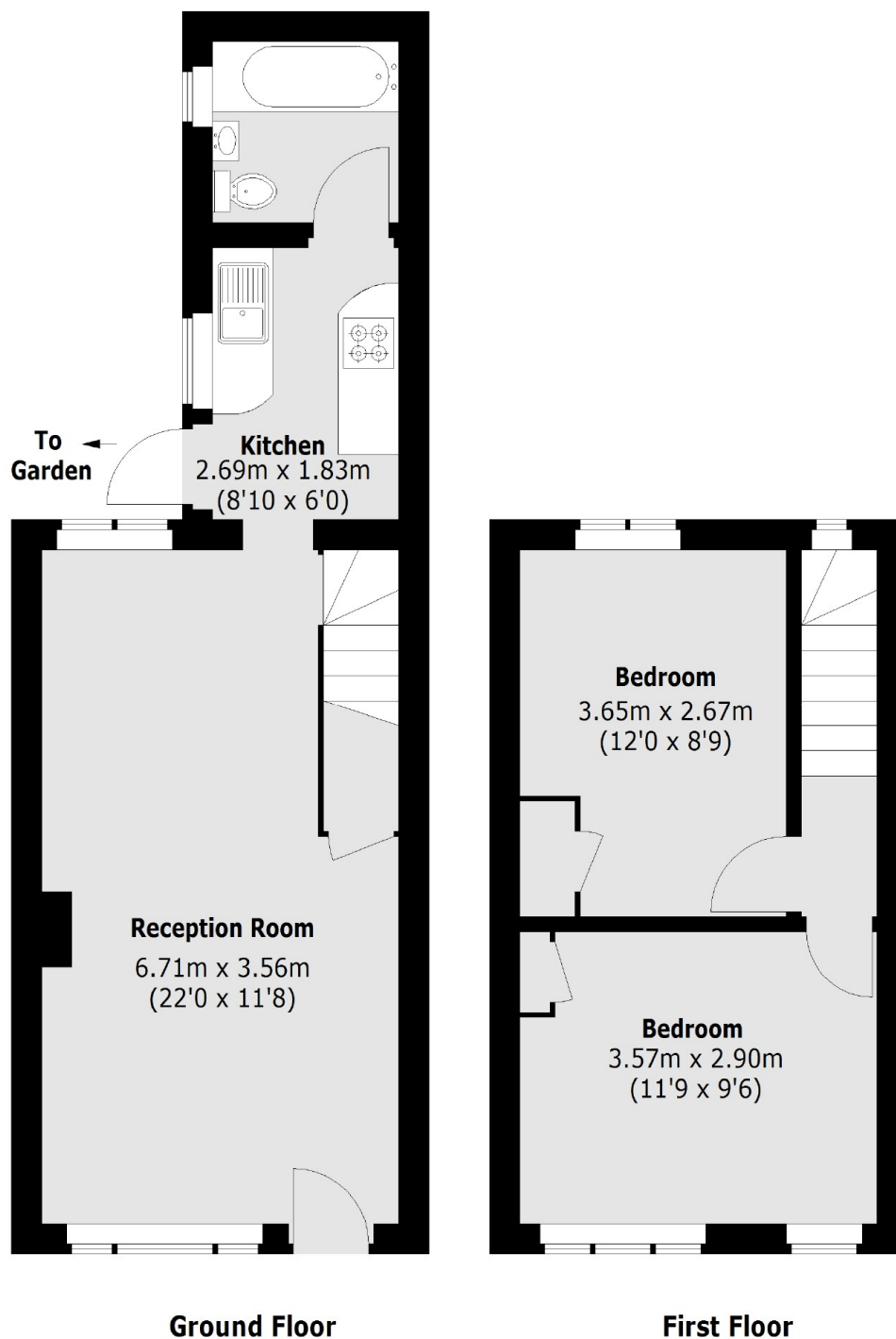

Total area (approx.): 57.3 sq. m (617.7 sq. ft)

Dexters

Richmond
1 Sheen Road
Richmond
TW9 1AD
Lettings
020 8288 0828

Energy Rating: C. We aim to make our particulars both accurate and reliable. However they are not guaranteed; nor do they form part of an offer or contract. If you require clarification on any points then please contact us, especially if you're traveling some distance to view. Please note that appliances and heating systems have not been tested and therefore no warranties can be given as to their good working order.

 **RICS** | Regulated
Estate Agent
and Letting Agent

[dexters.co.uk](https://www.dexters.co.uk)