



Beaumont Avenue, TW9

£650,000

Nestled in a sought-after location, this charming Edwardian red-brick flat offers an exceptional blend of period features and character. Boasting two spacious bedrooms, a generous living area, and a large private garden, this ground-floor flat is perfect for those seeking a blend of character and convenience. The property is Share Of Freehold; set on a quiet tree aligned residential road that with in close proximity to Richmond station.

Beaumont Road is centrally located and only 0.4 Miles from Richmond station which offers services into central London. The property is also located just moments from all the excellent amenities and restaurants of Kew Road with Kew Gardens and Old Deer Park nearby.

Features

- Two Bedrooms
- Edwardian Property
- South Facing Private Garden
- Share Of Freehold
- Central Location
- Potential To Extend (STPP)

Beaumont Avenue, Richmond, TW9

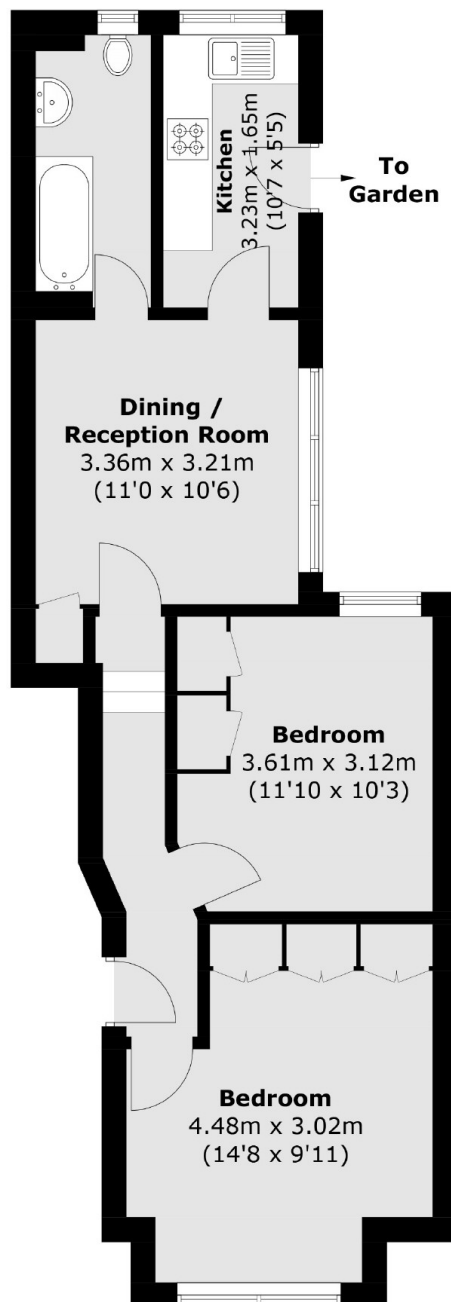

Total area (approx.): 54 sq. m (581.2 sq. ft)