



## Lower Mortlake Road, TW9

£675,000

Vetro House is a landmark building designed and built by Quad, an award winning local architect in 2006. At approximately 876 sq ft, this bright and spacious contemporary styled apartment makes for an ideal first time purchase, pied-a-terre or rental investment.

Lower Mortlake Road provides great access to the town centre of Richmond where a plethora of fine restaurants and eateries can be found amongst a vast array of shops, outstanding transport links, the River Thames and Richmond Park whilst also being conveniently situated beside the Royal Botanic Gardens, Kew and the Old Deer Park area.

### Features

- Two Double Bedrooms
- Open Plan Reception Room
- Open-Plan Kitchen
- Two Modern Bathrooms
- Underground Parking Space
- No Onward Chain



## Lower Mortlake Road, TW9

The apartment is entered by a private gate leading to the properties own front door.

The ground floor accommodation comprises a generous hallway with storage cupboard, a beautiful open plan kitchen/dining/living room with an abundance of light, exposed brickwork and high ceilings, a modern family bathroom, a double bedroom with an exposed feature concrete pillar, and a large master double bedroom with ensuite and walk-in dressing room.

The property also comes with a secure allocated underground parking space, which is accessed from Sheendale Road, a large private storage unit, a wrap around private terrace and is offered to the market with no onward chain. This particular property has been converted from the architect's previous office and is brand new.



# Lower Mortlake Road, Richmond, TW9

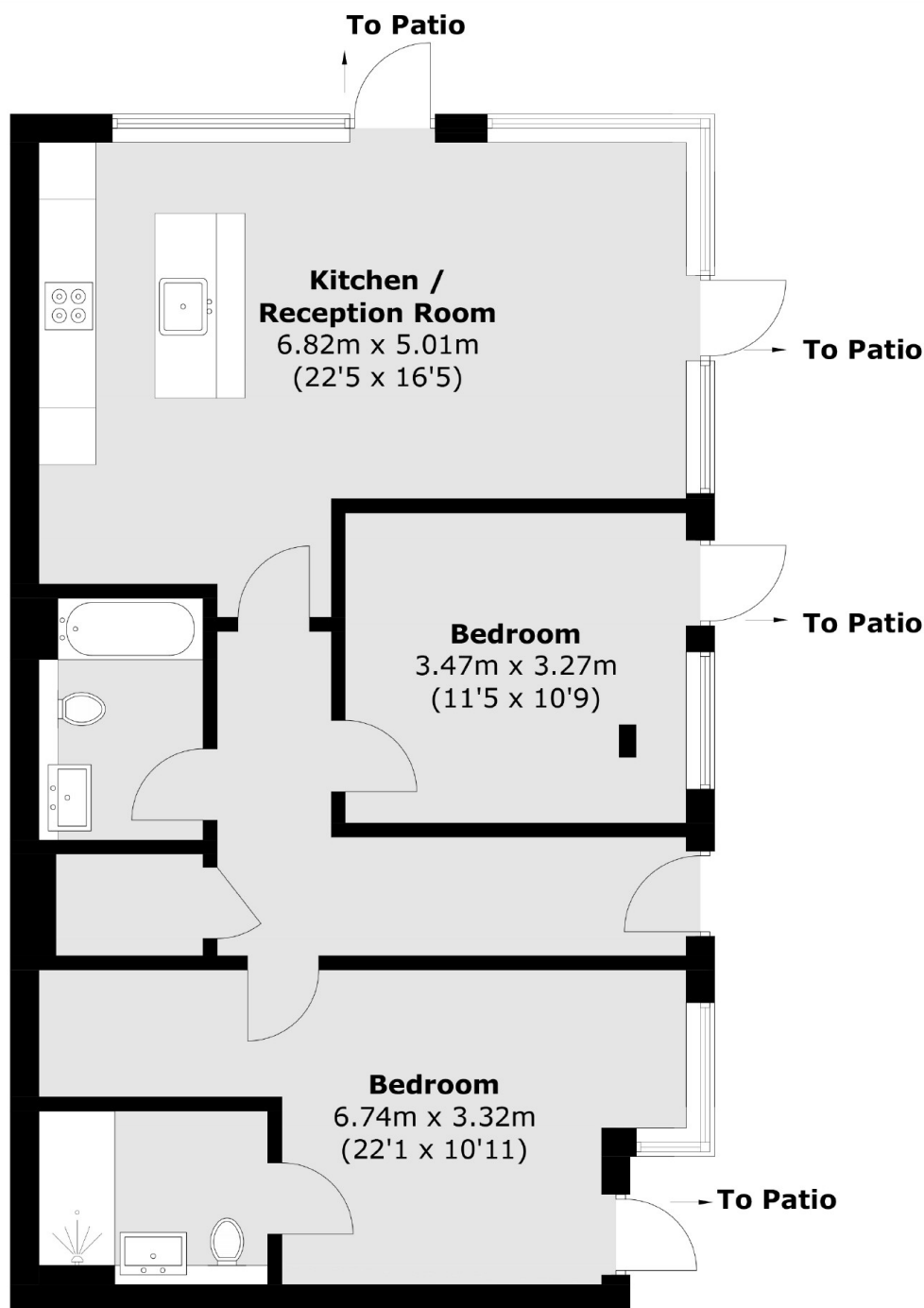

Total area (approx.): 81.4 sq. m (876.2 sq. ft)