



## Sheen Road, TW9

£325,000

A stunning purpose built apartment offering 441 sq ft of accommodation. The property has been completely refurbished throughout offering a modern and contemporary lifestyle interior and is offered to the market with a long leasehold interest.

The property is entered via a communal entrance hall with entry phone system and staircase leading to the first floor landing.

The first floor accommodation consists of an entrance hall with a storage cupboard, a reception room with storage cupboard and french doors leading to a Juliet balcony, a modern fitted kitchen/dining room, a double bedroom and a contemporary styled bathroom.

The property would make a perfect first time buy, pied-a-terre or suit an investment buyer and benefits from gas central heating and double glazing. Outside to the rear is a communal garden which is mostly laid to lawn. The front provides unallocated permit parking for residents.

Peldon Court, Sheen Road is ideally located for the amenities of Richmond town centre, with Richmond Park, Richmond Hill and Richmond Riverside all being close by. Richmond train station offers access to and from London by tube or rail via the District line, South

### Features

- Double Bedroom
- Reception Room
- Kitchen/Dining Room
- Modern Bathroom
- First Floor
- Long Lease

**Sheen Road,  
Richmond, TW9**

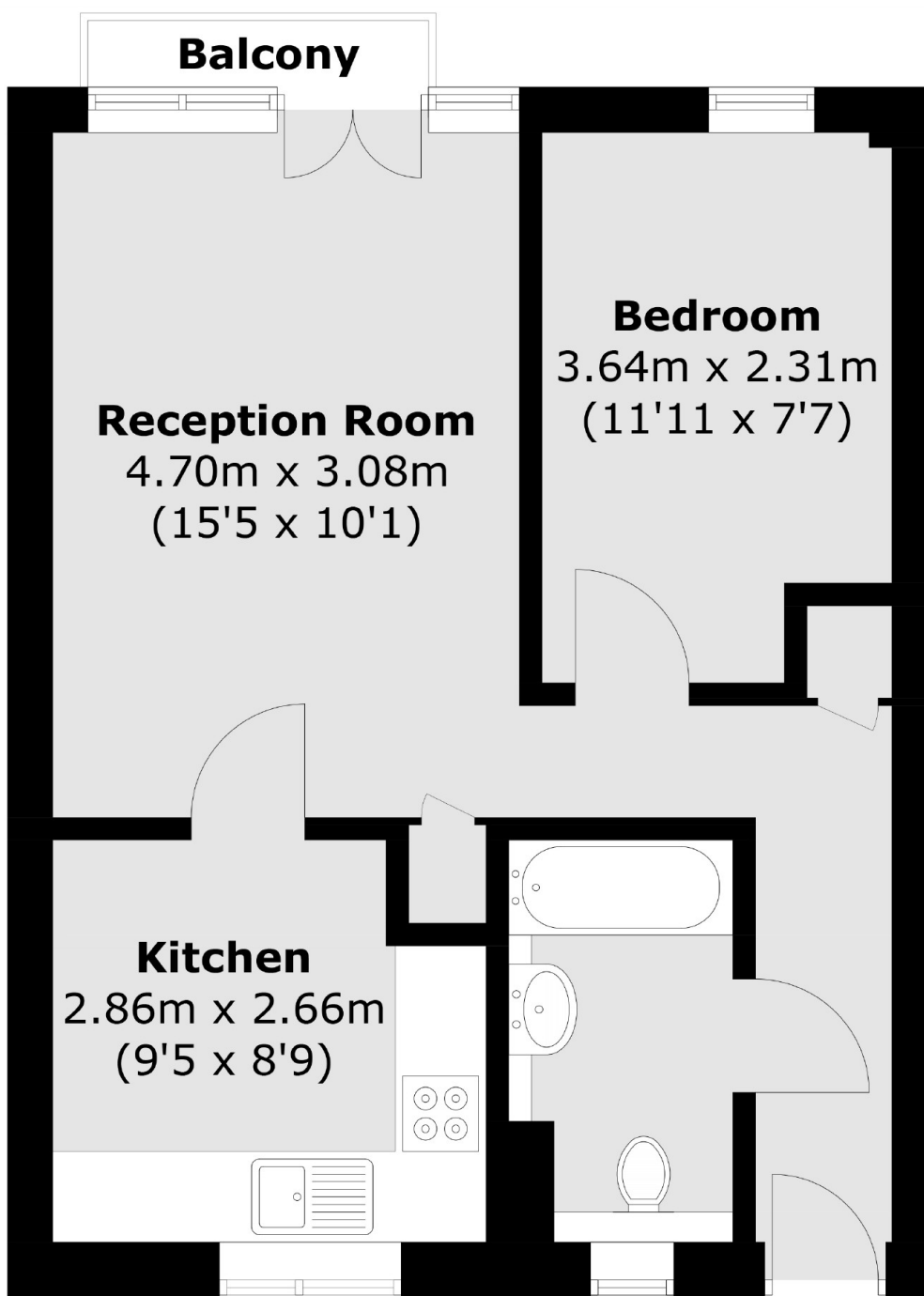

Total area (approx.): 41.0 sq. m (441.3 sq. ft)  
Balcony area: 1.0 sq. m (10.8 sq. ft)