



Townshend Terrace, TW9

£415,000

Located on the ground floor this larger than average apartment offers two double bedrooms, large reception room, a kitchen/dining room, bathroom with separate WC, double glazing throughout, and no onward chain. This would make for a perfect first time purchase or buy to let investor.

Robinson Court is situated 0.6 miles from the centre of Richmond, 0.3 miles from North Sheen station and 0.2 miles from Marshgate School which is Ofsted rated "Outstanding".

Features

- Two Double Bedrooms
- Open Plan Kitchen/Reception
- Ground Floor
- 813 sq ft
- External Storage Shed
- No Onward Chain

Townshend Terrace, Richmond, TW9

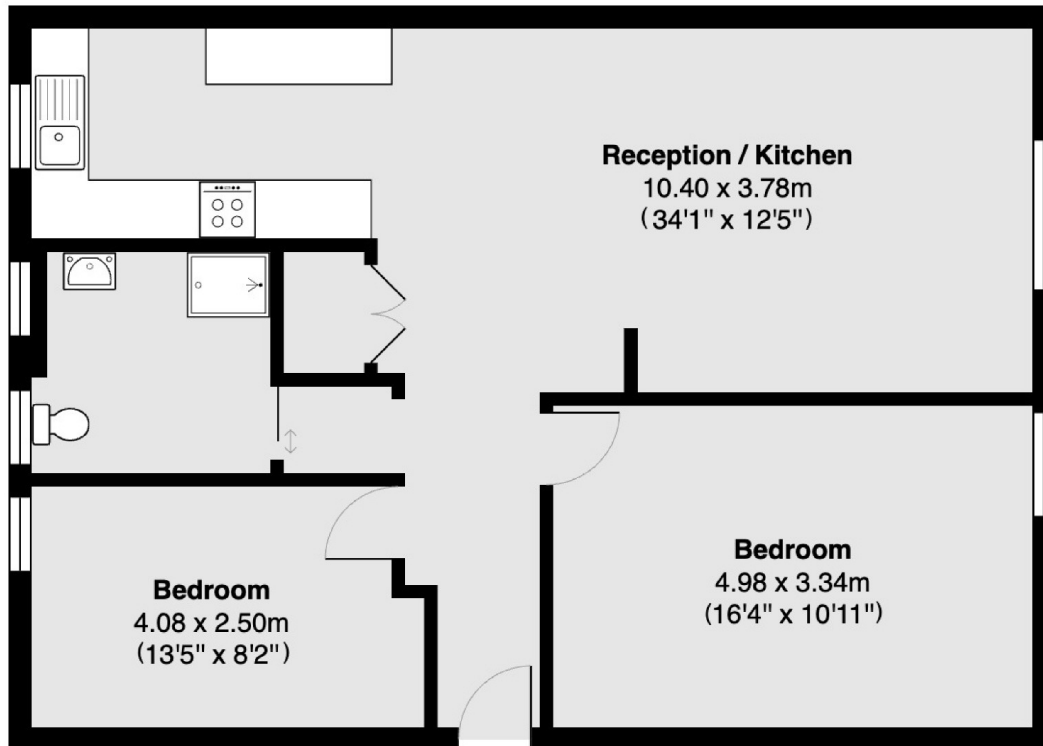

Total area 75.5 sq m (approx) (813 sq ft approx)