



## Little St. Leonards, SW14

£300,000

Moore Close, Little St. Leonards is a one bedroom ground floor flat well presented offering a well-proportioned reception room, a good sized double bedroom, a modern bathroom and kitchen. The property also offers the use of an communal garden and a convenient outside storage facility.

Close to Mortlake Station with direct access to Waterloo Station and all the local amenities of Upper Richmond Road.

### Features

- One Bedroom
- Ground Floor
- Excellent Condition
- Modern Kitchen
- Communal Gardens
- Outside Storage Facility

# Little St. Leonards, London, SW14

## Ground Floor

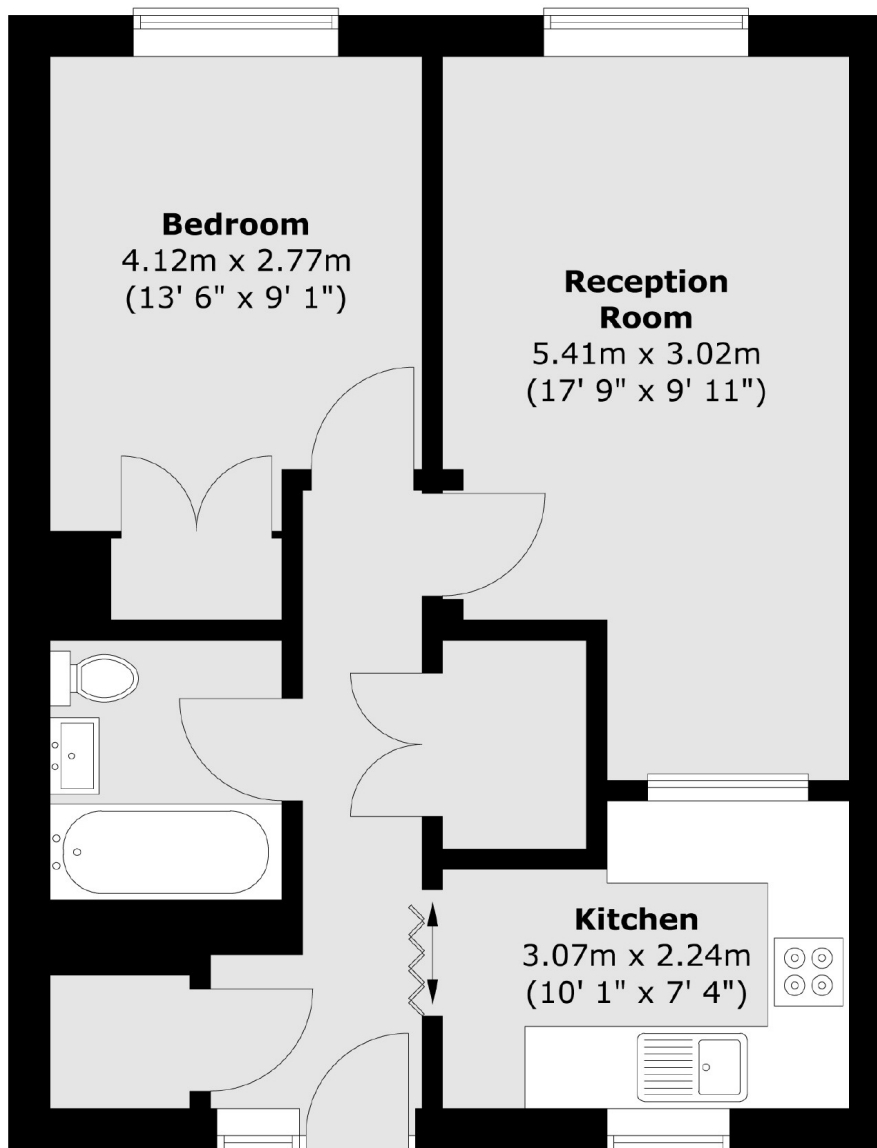

Total area (approx.) : 46.6 sq. m (502 sq. ft)