



Sheen Court, TW10

£575,000

A stunning bright and spacious two bedroom mansion block apartment located on the second floor within the popular Sheen Court development. The property is offered with no onward chain, a share of the freehold and low service charge costs.

Sheen Court is a well maintained private sought after residential development set within extensive communal grounds. Richmond and North Sheen stations offer tube or rail services into Central London via the District Line, South West Trains and London Overground.

Features

- Two Double Bedrooms
- Spacious Reception Room
- Bespoke Fitted Kitchen
- West Facing Balcony
- Residents Parking
- No Onward Chain



Sheen Court, TW10

The property is entered via a well maintained communal entrance hall with entryphone system with a communal turning staircase leading to the second floor communal landing. The accommodation consists of an entrance hall with storage cupboard, a spacious reception room with a door leading to a west facing balcony, a fully fitted kitchen with integrated appliances, two double bedrooms with fitted wardrobes and a modern family bathroom.

Outside are well stocked and maintained communal gardens with resident parking (garages are available to rent, subject to availability). The development further benefits from an onsite caretaker and from communal heating and water.

The property would appeal to professionals and families alike as it is centrally located for a number of Ofsted rated outstanding schools including Holy Trinity, Marshgate and St Elizabeth's.



Sheen Court, Richmond, TW10

Second Floor

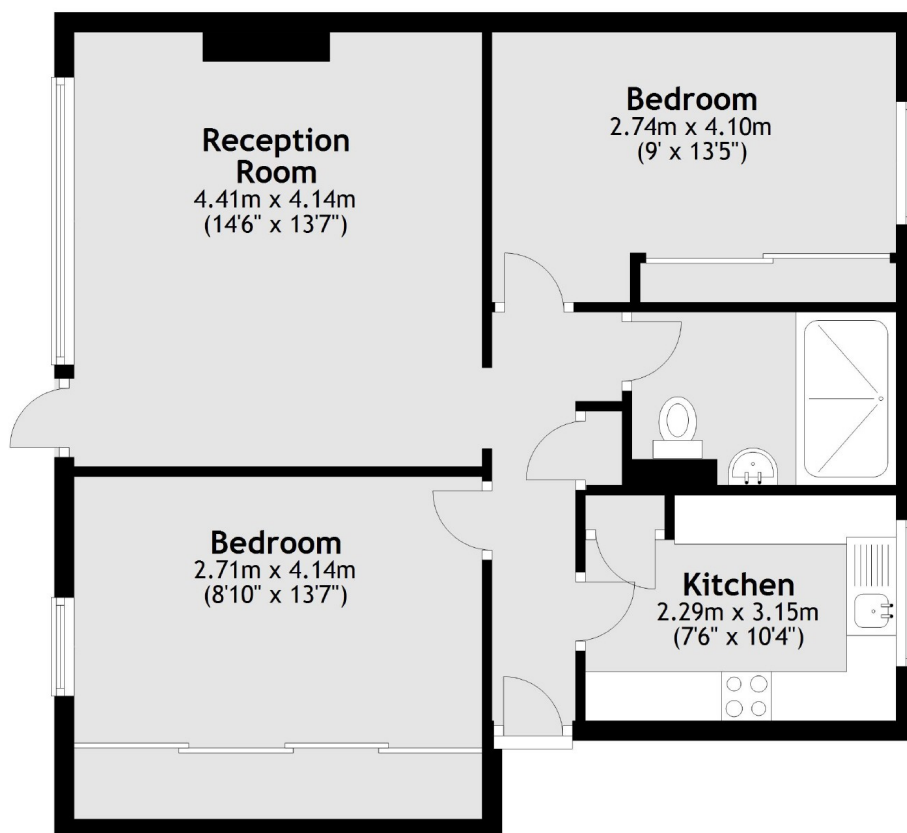

Total area: approx. 62.4 sq. metres (672.1 sq. feet)