



Levett Square, TW9

£450,000

Built by Taylor Wimpey, circa 2018, is this beautifully presented purpose built apartment offering approximately 637 sq ft of accommodation. The property has a modern and contemporary styled decorative finish featuring luxury 'state of the art' interior fittings.

Levett Square is a recently built sought after residential development set within a communal landscaped square and benefitting from a 24/7 onsite concierge service. Located within easy reach of the Thames Path, Kew Retail Park, Kew Gardens Station providing District Line and Overground services and the local village shopping amenities.

Features

- One Double Bedroom
- Spacious Reception Room
- Modern Fitted Kitchen
- 24/7 Concierge
- Private Balcony
- Underground Private Parking



Levett Square, TW9

The property is entered via a well maintained communal entrance hall with secure video entry phone system and provides lift and staircase access to the first floor communal landing with door into the property.

The accommodation consists of an entrance hall with a large storage cupboard, a spacious reception room with a door leading to the private balcony, a semi separated, fully fitted modern kitchen with integrated appliances, a double bedroom with a sliding door leading to the private balcony and a contemporary styled modern bathroom.

The property benefits from double glazing throughout, integrated ventilation and heat recovery system, secure residents bicycle storage, and a gated underground allocated parking space.



Levett Square, Kew, TW9

First Floor

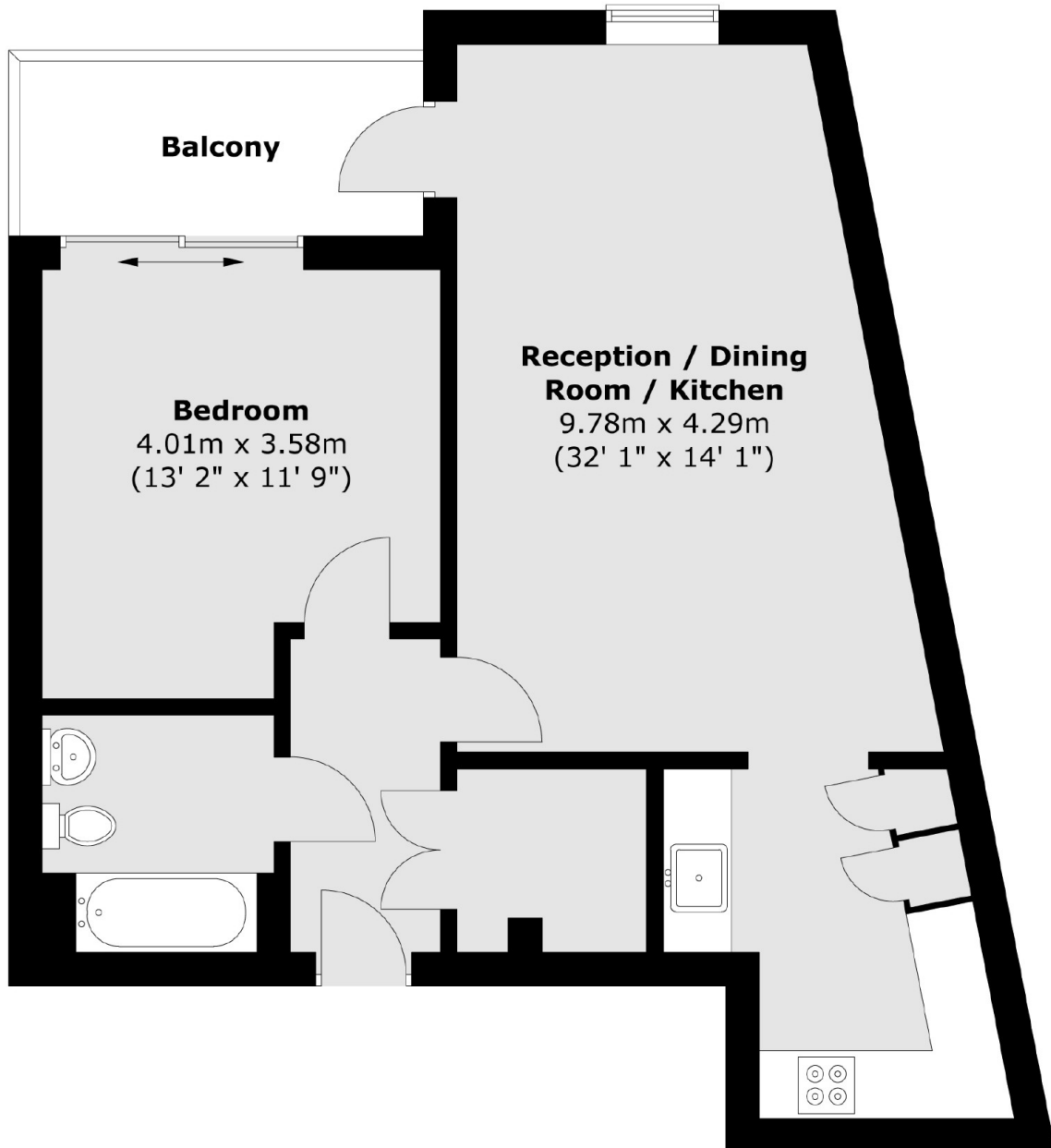

Total area (approx.) : 59.2 sq. m (637 sq. ft)
Total balcony area (approx.) : 5.4 sq. m (58 sq. ft)