



## Strand Drive, TW9

£585,000

A two bedroom apartment in this purpose-built riverside development with an east-facing balcony, a bright open plan reception room, access to a residents gym and secure underground parking.

Dorchester House is in a prime location with direct access to the River Thames path and Kew Gardens underground station just a 10 minute walk away. Kew Gardens and Kew Retail Park are within walking distance and the M4 motorway a short drive.

### Features

- East-Facing Balcony
- Riverside Development
- Secure Parking
- Residents Gym
- Two Bedrooms
- Modern Finish

# Strand Drive, Kew, TW9

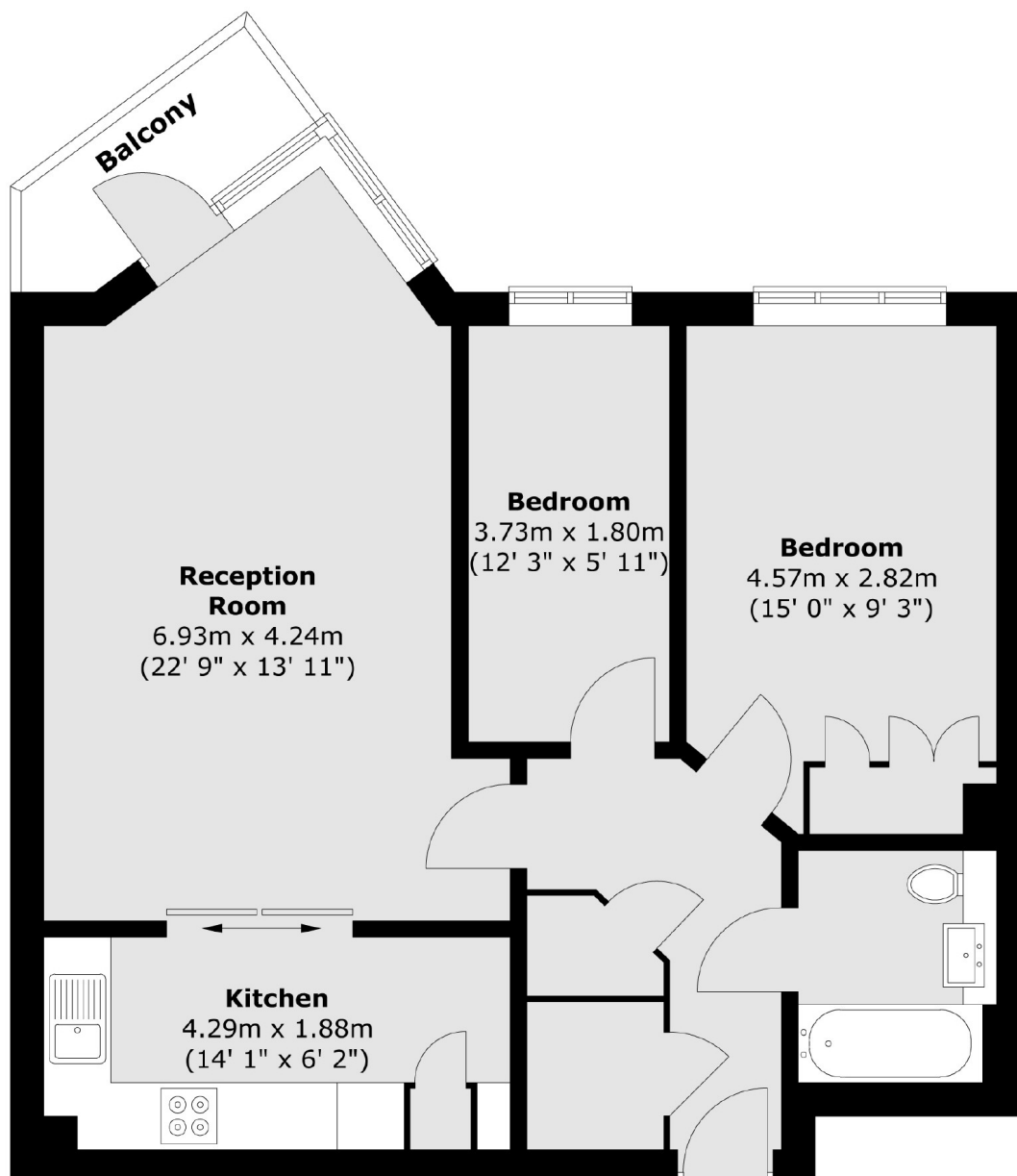

Total area (approx.) : 66.2 sq. m (713 sq. ft)