



## Sandycombe Road, TW9

£499,950

A spacious and well-maintained one double bedroom apartment set on the ground floor of this attractive period building. The apartment, which spans circa 592 sq ft of living space, comes with the added benefits of a large private garden, underfloor heating throughout, and a share of the freehold.

Sandycombe Road is ideally located for the shops and restaurants of Kew Village, as well as the Royal Botanic Gardens Kew and Richmond Park. The commuter is equally well catered for with Kew Gardens, Richmond and North Sheen stations close to hand with additional excellent bus services to Central London.

### Features

- One Double Bedroom
- Approx 592 sq ft
- Private Garden
- Period Conversion
- Share Of Freehold
- Kew Village

# Sandycombe Road, Kew, TW9

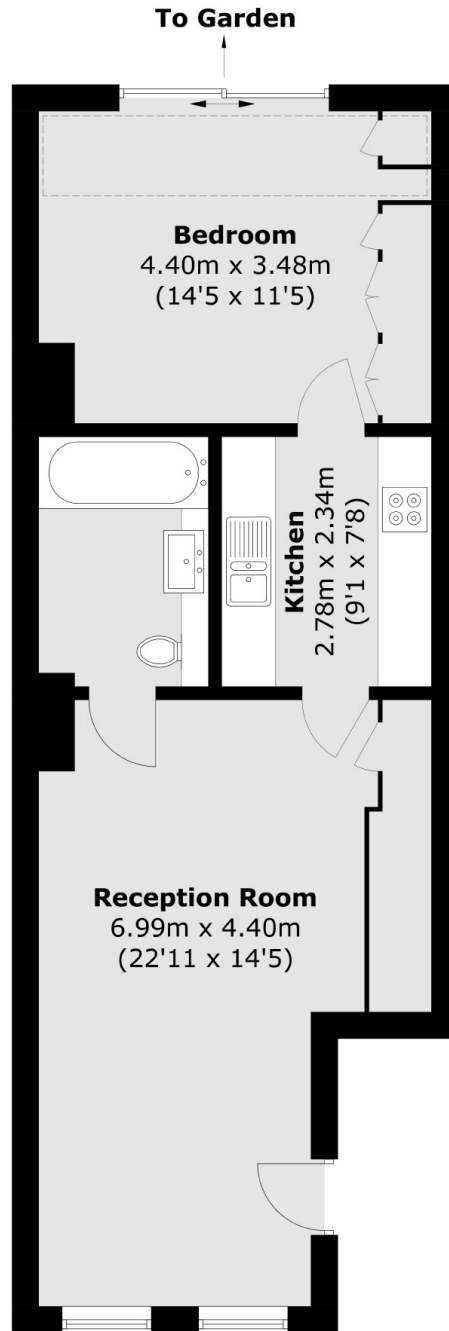

Total area (approx.): 55.0 sq. m (592.0 sq. ft)

## Dexters

Richmond  
1 Sheen Road  
Richmond  
TW9 1AD

Sales  
020 8288 9988

Energy Rating: D. We aim to make our particulars both accurate and reliable. However they are not guaranteed; nor do they form part of an offer or contract. If you require clarification on any points then please contact us, especially if you're traveling some distance to view. Please note that appliances and heating systems have not been tested and therefore no warranties can be given as to their good working order.

 **RICS** | Regulated  
Estate Agent  
and Letting Agent

[dexters.co.uk](http://dexters.co.uk)