



Church Road, TW10

£2,600 Per calendar month

This two double bedroom Edwardian conversion flat will be perfect for a professional couple. With wood floors throughout, open plan kitchen reception room and direct access to a large communal garden.

Church Road is convenient for everything Richmond has to offer. Moments from Richmond Station and a short walk to the parade of shops on Richmond Hill with Sainsburys Local and an array of dining options.

Features

- Two Double Bedrooms
- Raised Ground Floor
- Wood Floors
- Open Plan Living Area
- Access To Gardens
- Edwardian Conversion

Church Road, Richmond, TW10

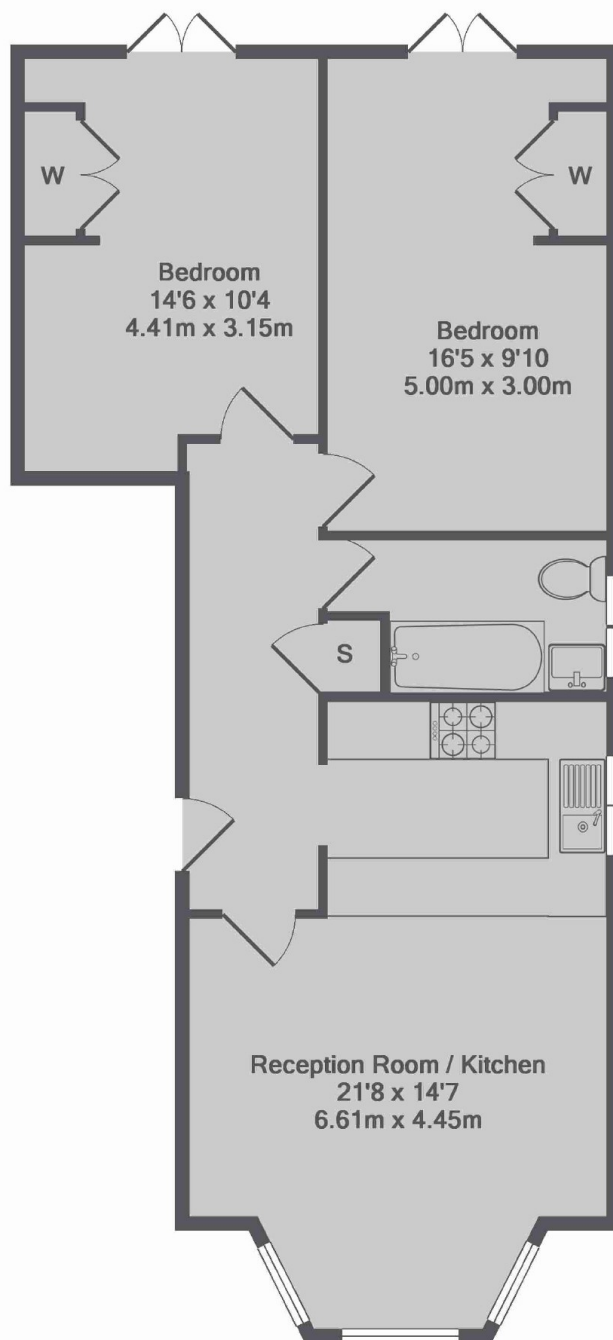

Church Road, TW10
Total Approx. Floor Area 691 Sq.Ft. (64.2 Sq.M.)