



Strand Drive, TW9

£599,950

An opportunity to acquire this beautifully presented purpose built ground floor apartment within one of Kew's most desired gated developments. This stunning two-bedroom, two-bathroom property, sold chain free, offers a buyer low maintenance living with a private terrace and views over the beautifully maintained communal gardens. The versatile second bedroom opens up to create extra living space.

The property benefits from an allocated parking space with additional spaces available to rent, a 24/7 on-site concierge and security and an onsite residents gym.

Earls House is in a prime location with direct access to the River Thames path and Kew Gardens underground station just a 10 minute walk away. Kew Gardens and Kew Retail Park are within walking distance and the M4 motorway a short drive.

Features

- Two Bedrooms
- Private Terrace
- On-Site Concierge
- Residents Gym
- Allocated Off Street Parking
- No Onward Chain

Strand Drive, Kew, TW9

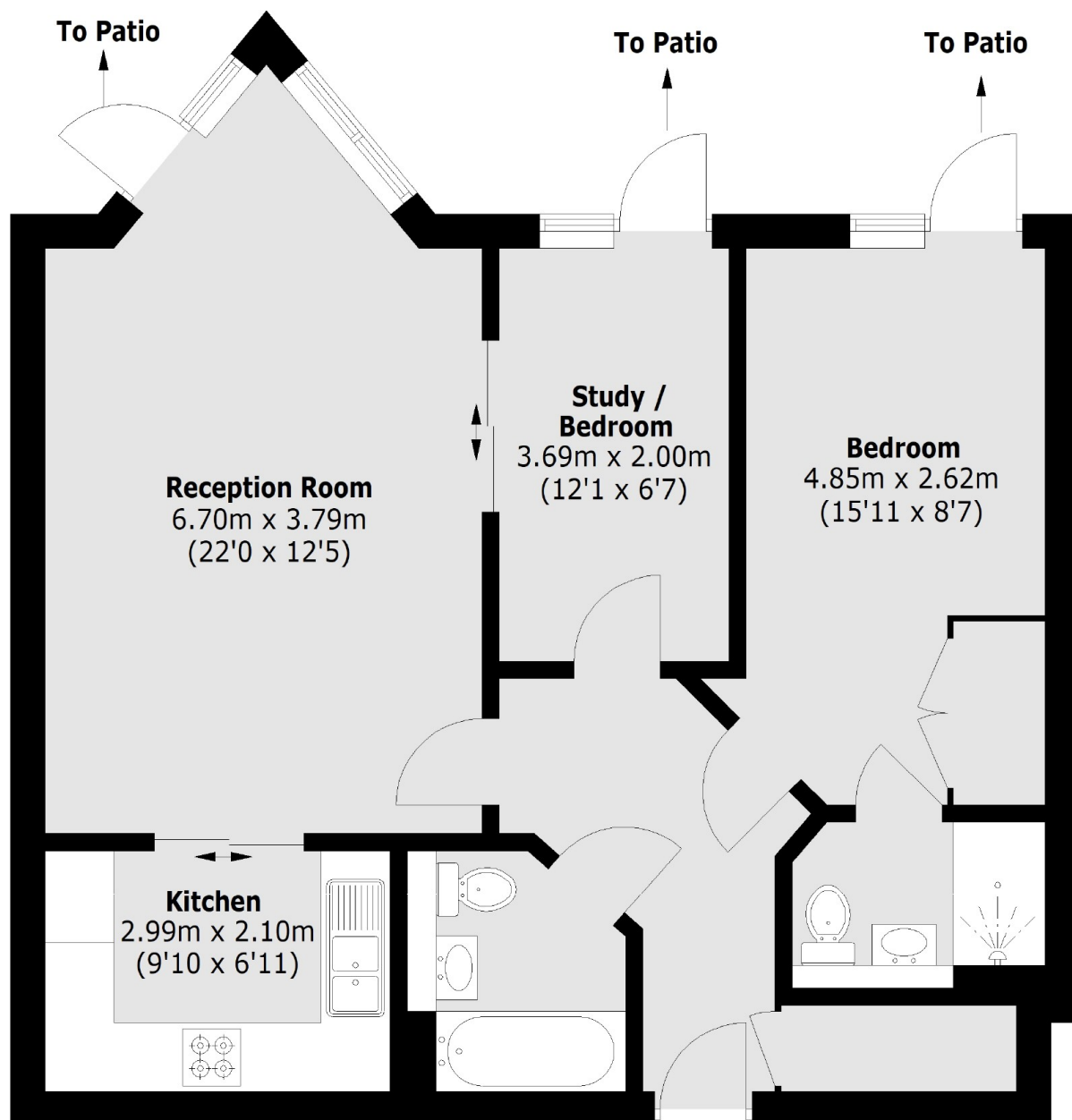

Ground Floor

Total area (approx.): 66.4 sq. m (714.7 Sq. ft)