



Sheen Road, TW9

£2,375 Per calendar month

A large three bedroom ground floor apartment offers plenty of storage. With communal gardens and a gate directly into Richmond train station, you could not be more central with this property.

Lichfield Court is in the heart of Richmond's bustling town centre but the development has a tranquil feel to it. Conveniently next to a large supermarket and local coffee shops.

Features

- Three Bedrooms
- Large Reception
- Separate Kitchen
- Modern Bathroom
- Ample Storage
- Residents Parking

Sheen Road, Richmond, TW9

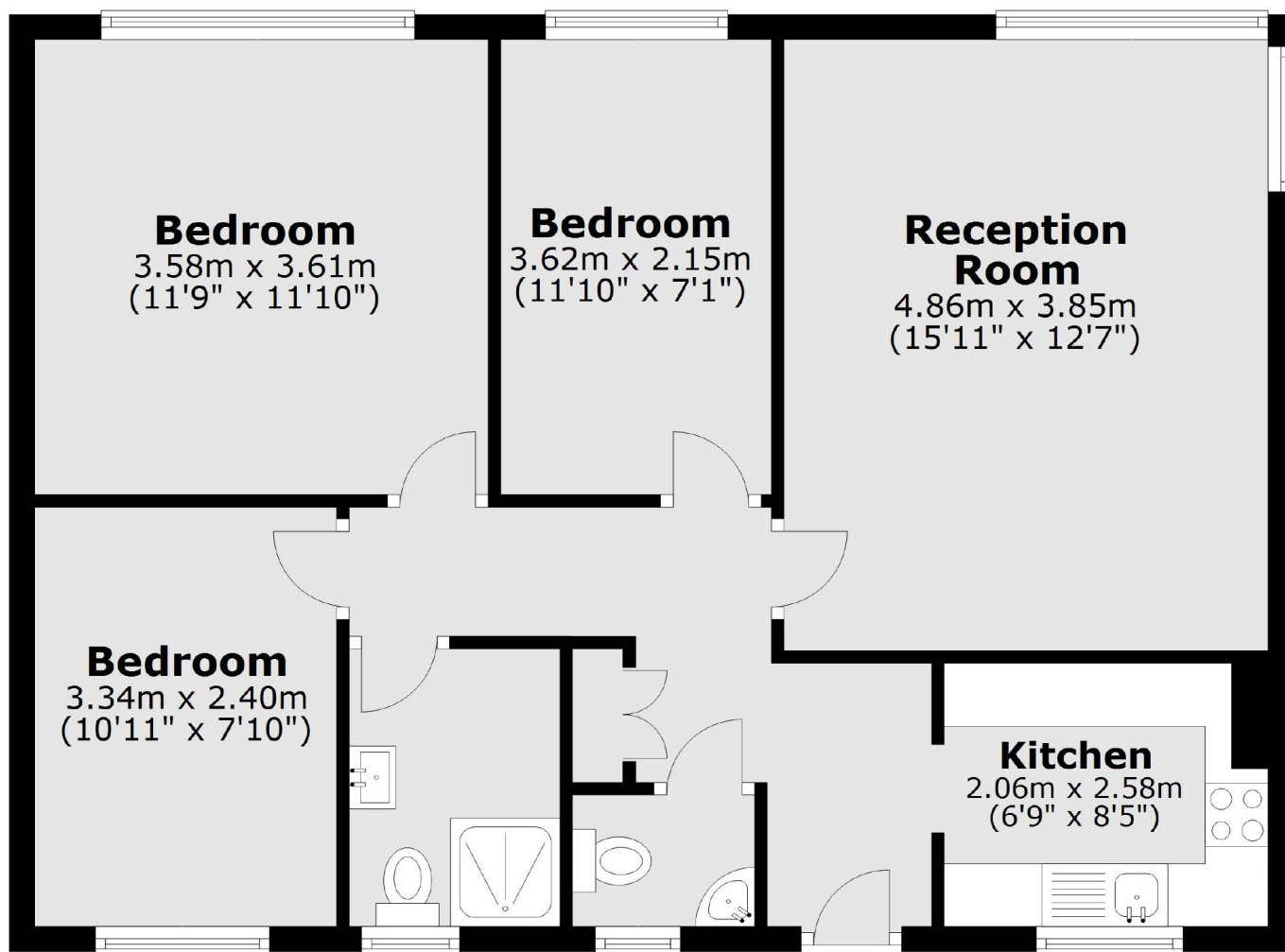

Total area: approx. 69.1 sq. metres (743.7 sq. feet)