



Sheen Road, TW9

£275,000

A bright and airy one bedroom apartment situated on the second floor of the prestigious over 55's gated development Northumbria Court. The flat is laid out across approximately 424 sq ft and offers lift access, an allocated parking space, and beautiful communal gardens.

Situated on Sheen Road in central Richmond, the property is well located for the amenities on Richmond Hill, with Richmond Park, Richmond Riverside and Richmond town centre all being close by, Richmond station offers services, to and from London, by tube or rail via the District line and South West trains.

Features

- One Double Bedroom
- Modern Fitted Kitchen
- Allocated Parking Space
- Communal Gardens
- Central Location
- Gated Development

Sheen Road, Richmond, TW9

Second Floor

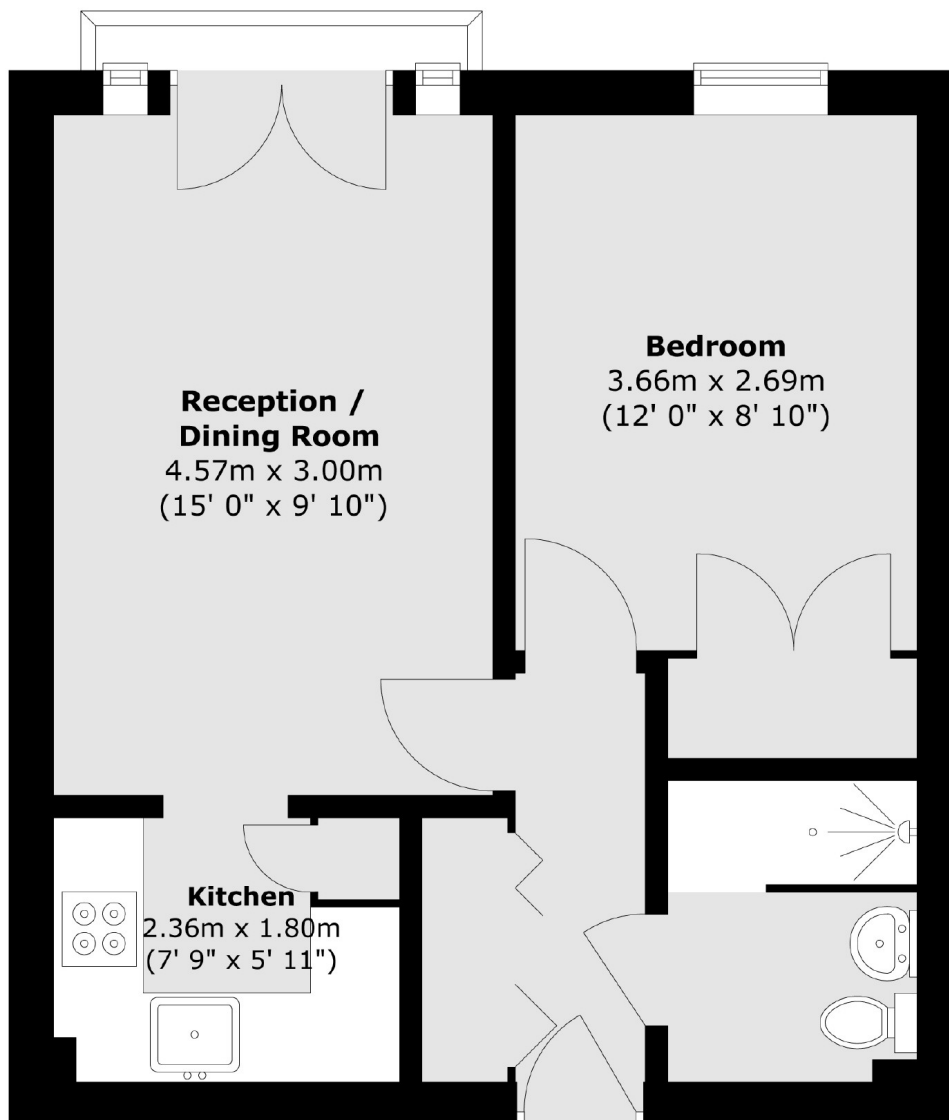

Total area (approx.) : 39.4 sq. m (424 sq. ft)
Total balcony area (approx.) : 0.8 sq. m (8 sq. ft)