



Upper Richmond Road, SW15

£475,000

A beautifully presented two bedroom apartment located on the third floor within the highly desirable Ormonde Court.

The property comprises, modern fitted kitchen, open plan reception room with space to dine, master bedroom with built in storage, second double bedroom and a beautiful modern bathroom suite. The property further benefits from beautiful wooden flooring in the living space, communal gardens, porter, telephone entry system and lift access. There is also the use of a Basement lock up unit, ideal for additional storage.

Ormonde Court benefits from being in a central location, with Putney Station approximately 0.5 miles away, Barnes Station approximately 0.6 miles away and East Putney Underground Station approximately 0.7 miles away.

Service charge: £3,350

Reserve fund/maintenance: £1,975

Features

- Two Bedroom
- 693 sqft
- Basement Storage Unit
- Lift Access
- Communal Gardens
- Communal heating

Upper Richmond Road, London, SW15

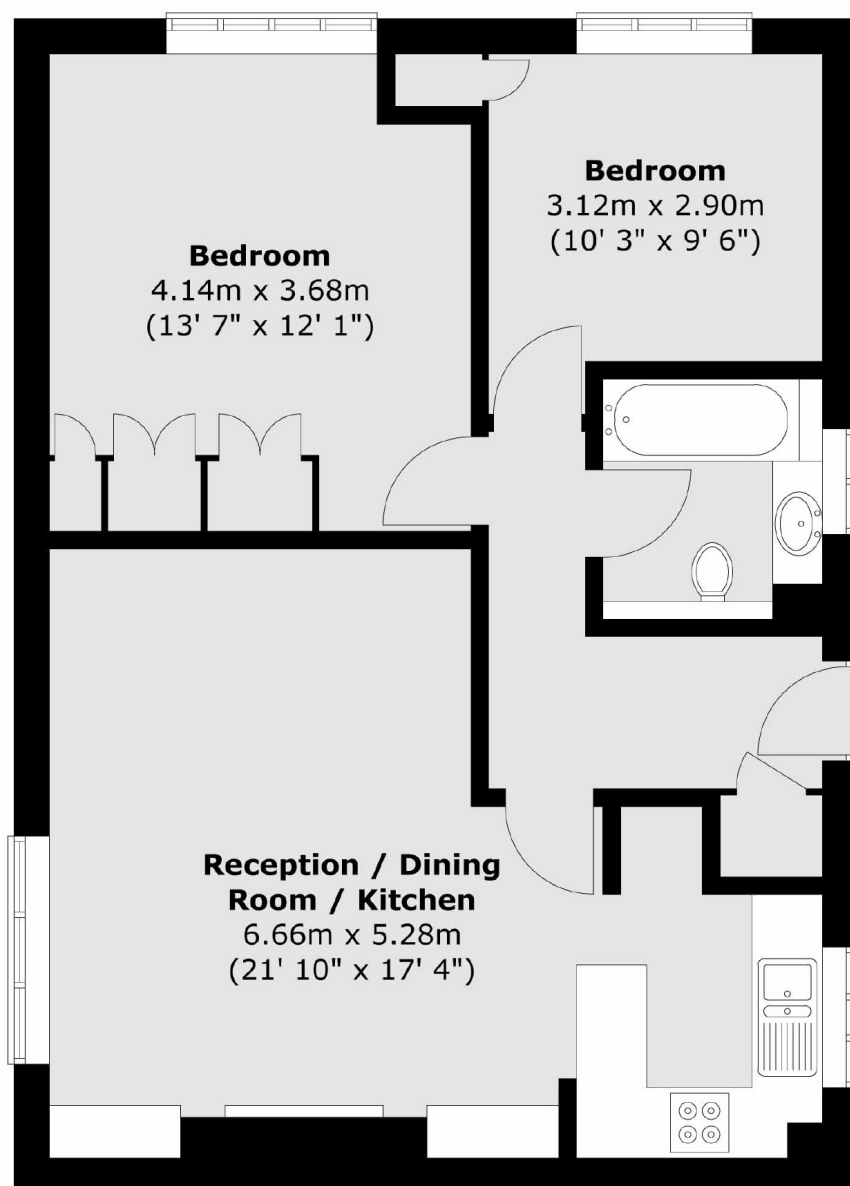

Total area (approx.) : 64.4 sq. m (693 sq. ft)

Dexters

Putney
176 Putney High Street
London
SW15 1RS
Sales
020 8789 9999

Energy Rating: . We aim to make our particulars both accurate and reliable. However they are not guaranteed; nor do they form part of an offer or contract. If you require clarification on any points then please contact us, especially if you're traveling some distance to view. Please note that appliances and heating systems have not been tested and therefore no warranties can be given as to their good working order.

 **RICS** | Regulated
Estate Agent
and Letting Agent

[dexters.co.uk](https://www.dexters.co.uk)