



Werter Road, SW15

£750,000

Dexters



Werter Road, SW15

This large, 1127sqft three bedroom ground floor apartment, is split over two levels and is situated on one of the most desirable roads in Putney. Benefitting from period features throughout this highly versatile flat also offers direct access onto a Large South facing garden. A brand new 999 year lease is in the process of being registered at HM Land Registry.

As you enter, you are welcomed by a bright living room with high ceilings and period features. This level also offers two bedrooms: a large double with built-in storage, ornate cornicing and French windows onto the garden, and a second well-sized double with a sash window. The lower floor includes another spacious double bedroom, a bathroom, separate WC, storage cupboard, and a large eat-in kitchen opening directly onto the garden.

Werter Road is just off Putney High Street, between the station, River Thames and Wandsworth Park. Just moments from East Putney Tube and Putney station.

Features

Offers in excess of
1124 sqft
Lease being extended to 999
Years
Three Bedrooms
Chain free







Werter Road, London, SW15

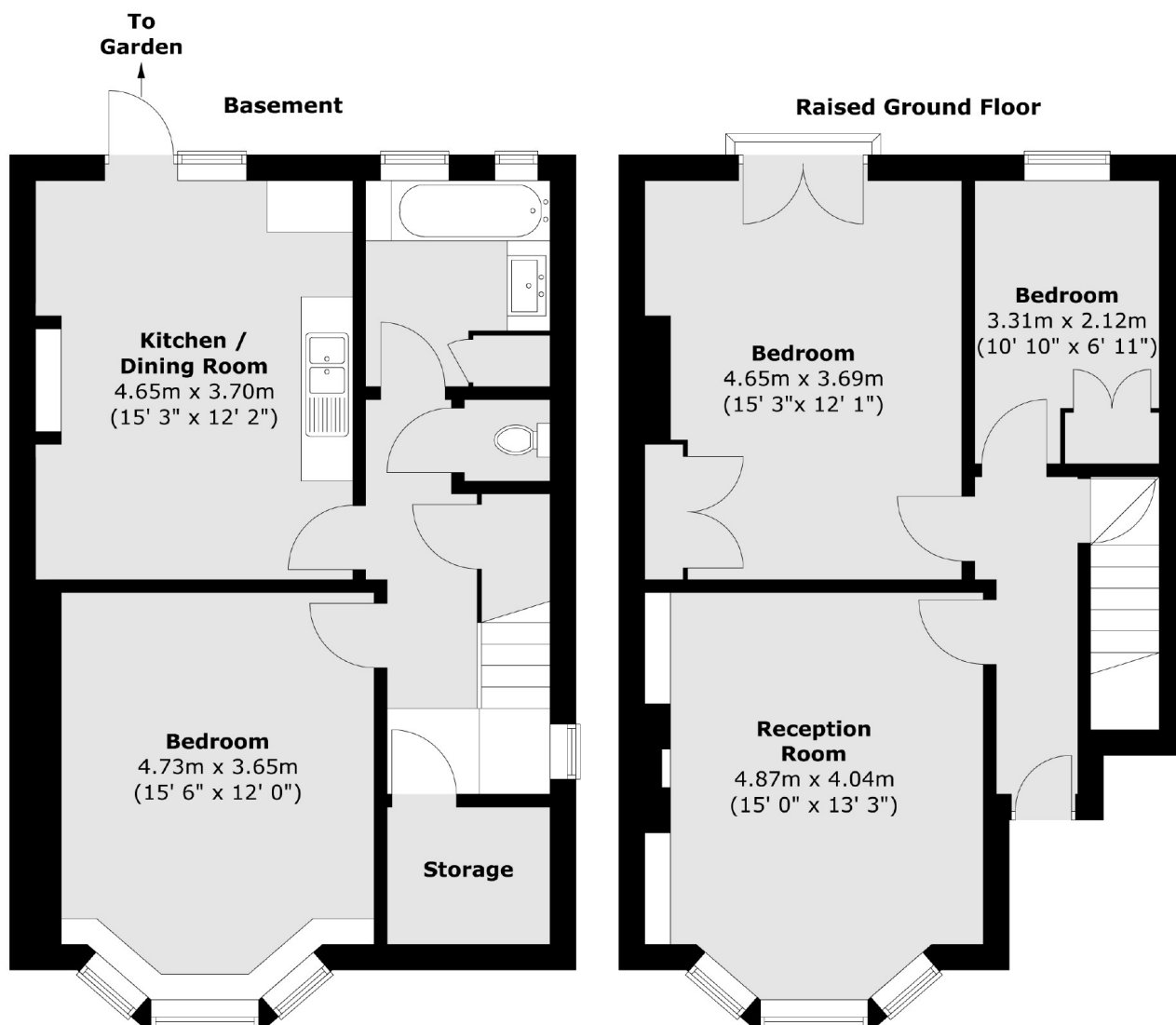

Total area (approx.) : 104.4 sq. m (1124 sq. ft)
Total balcony area (approx.) : 0.2 sq. m (2 sq. ft)