



The Footpath, SW15
£750,000

Dexters



The Footpath, SW15

A newly refurbished, two/three bedroom, terrace family home with a large garden and the potential (STP) to be further extended. Located in the sought after Dover House Estate.

The Footpath is a quiet residential street towards the Putney Heath end of the estate so ideal for easy access onto Richmond Park and Wimbledon Common.

Features

- Almost 800 sq ft
- Newly refurbished
- Flexible Layout
- Incredible Garden
- Potential To Extend (STP)
- No Chain







The Footpath, London, SW15

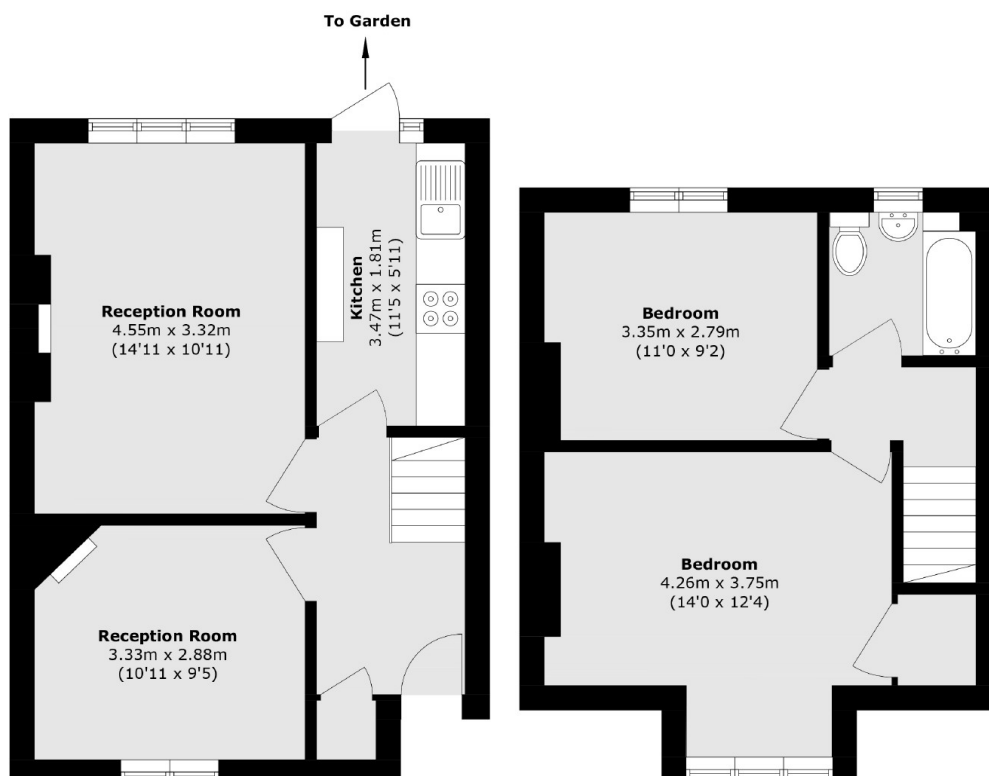

Total area (approx.): 71.4 sq. m (768.5 sq. ft)