



Portinscale Road, SW15

£545,000

An 880 sqft, two-bedroom, first-floor apartment is set within this well-maintained residential building just off West Hill. This spacious property comprises two generous double bedrooms, a light and spacious living room benefiting from large floor to ceiling windows and original parquet flooring. The flat also has a separate fitted kitchen with integrated appliances, bathroom and a separate w.c. The property also benefits from a lift, a beautifully kept communal garden and no onward chain.

Burton Lodge is located just moments away from a variety of Putney's trendy shops, bars and restaurants not forgetting excellent transport links in and out of London.

Features

- 880 sqft
- Two Bedrooms
- Chain Free
- Parquet Flooring
- Communal Gardens
- On Site Permit Parking

Portinscale Road, London, SW15

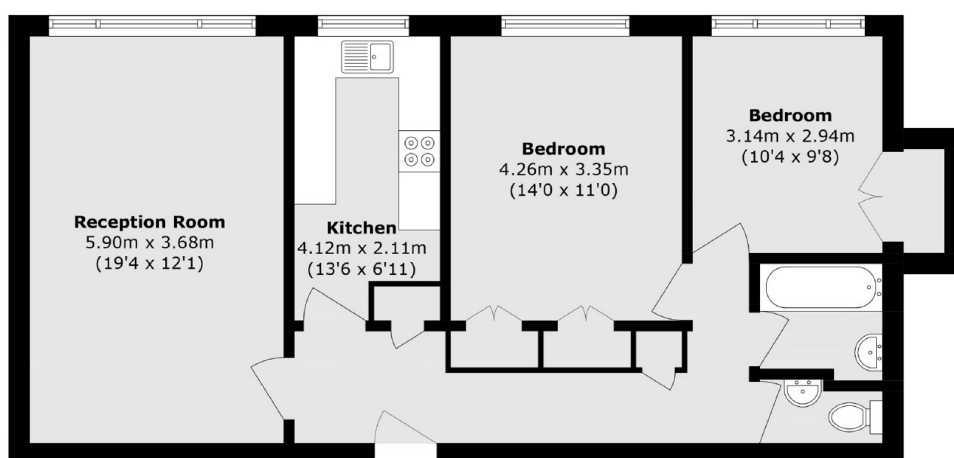

Total area (approx.): 81.8 sq. m (880.5 sq. ft)