



## Cortis Road, SW15

### £350,000

This spacious two bedroom flat is nicely positioned on the Ashburton Estate and has a balcony overlooking green space. The flat is presented in good condition with a modern Kitchen and has double glazing.

Cortis Road is part of the Ashburton Estate that was built in the late 1950s on the site of Gifford House, a country house that had been abandoned after being used as a military hospital during World War One.

### Features

- Two Bedrooms
- Second Floor
- Ex-Local Authority
- Quiet Location
- Private Balcony
- Chain Free

# Cortis Road, London, SW15

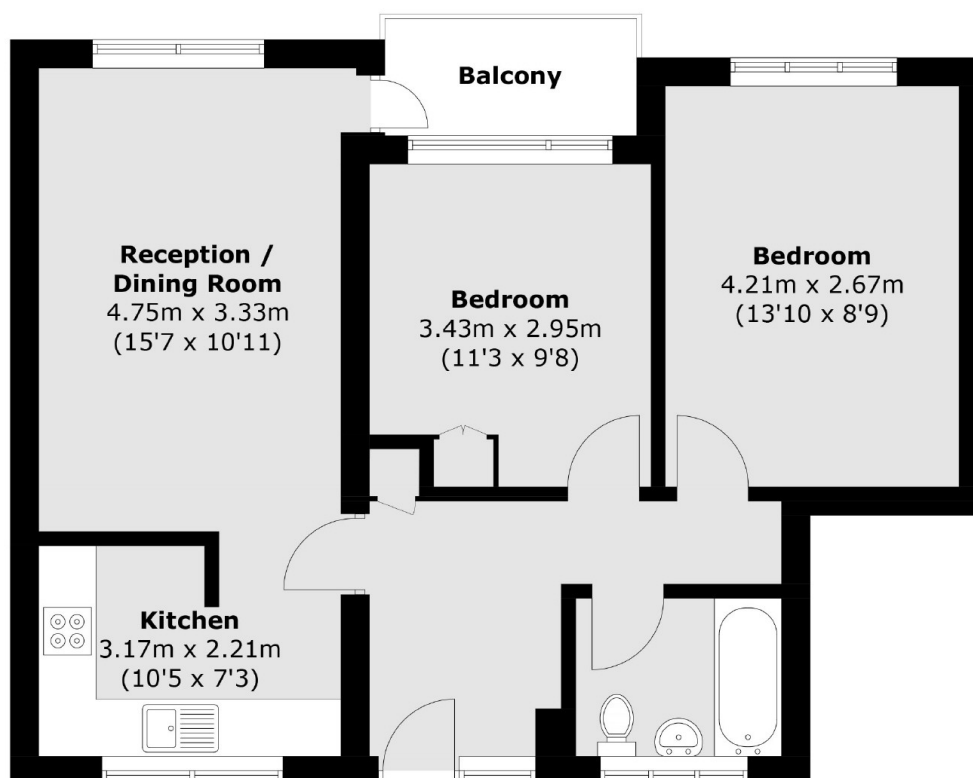

Total area (approx.): 60.9 sq. m (655.5 sq. ft)  
Balcony : 3.2 sq. m (34.4 sq. ft)

## Dexters

Putney  
176 Putney High Street  
London  
SW15 1RS  
Sales  
020 8789 9999

Energy Rating: . We aim to make our particulars both accurate and reliable. However they are not guaranteed; nor do they form part of an offer or contract. If you require clarification on any points then please contact us, especially if you're traveling some distance to view. Please note that appliances and heating systems have not been tested and therefore no warranties can be given as to their good working order.

 **RICS** | Regulated  
Estate Agent  
and Letting Agent

[dexters.co.uk](https://www.dexters.co.uk)