



## Burghley Hall Close, SW19

£375,000

This ground floor apartment was built in the 1990s and has a 999 year lease as well as a communal garden and allocated parking. The flat is in good condition and ready to move in. With low council tax and service charges, and Southfields Village and station just up the road, this flat is ideal for a first-time buyer.

Burghley Hall Close is between Wimbledon Common and Southfields Village. The district line station is a short walk away or there are a few buses into Putney and Wimbledon if needed.

### Features

- Two Bedrooms
- Ground Floor
- 999 Year Lease
- Parking
- Communal Garden
- No chain

# Burghley Hall Close, London, SW19

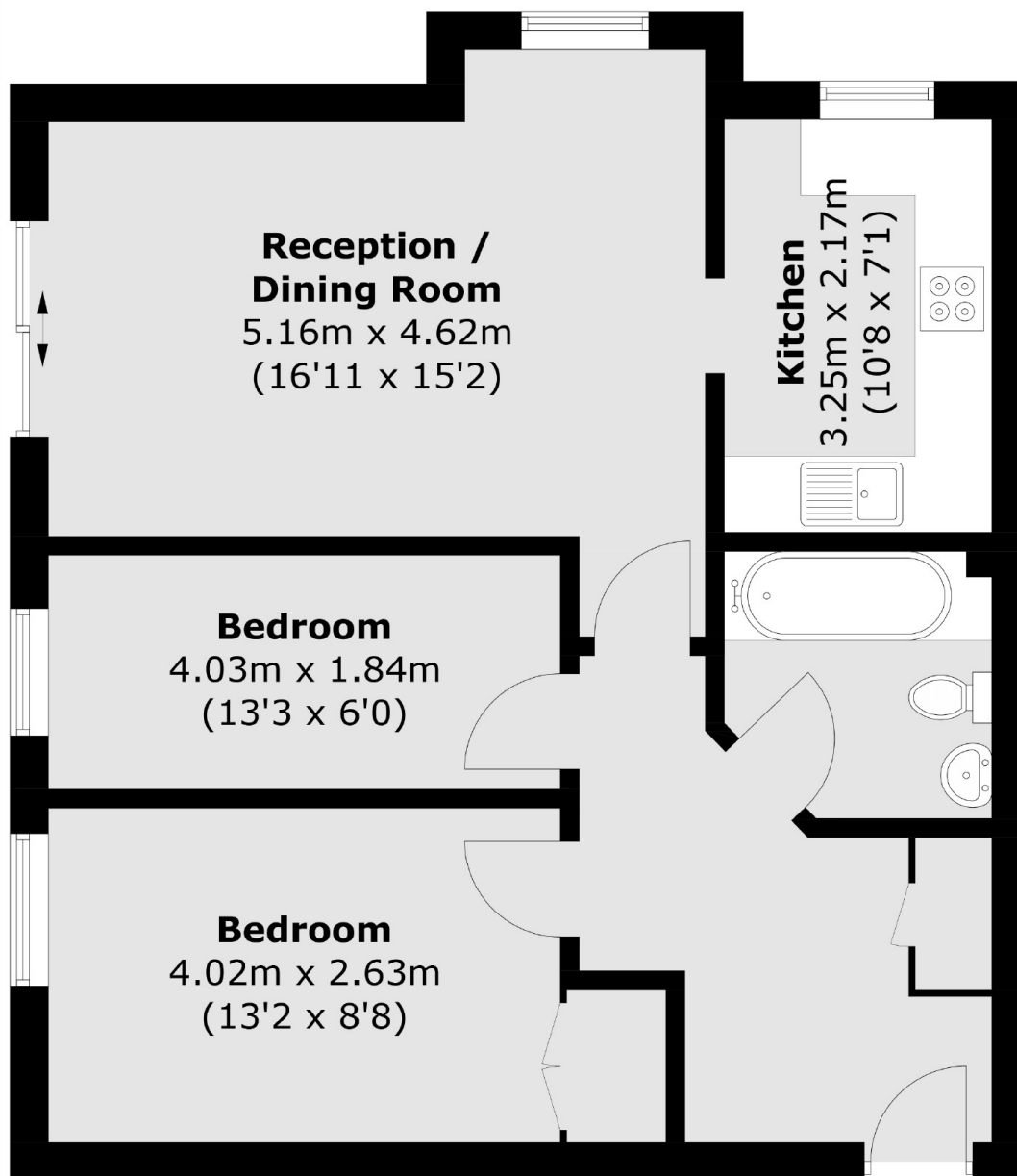

## Ground Floor

Total area (approx.): 61.0 sq. m (656.0 sq. ft)